

## Effisus Stopper MR

### Confirming pipe diameter and cutting Effisus Stopper MR



1

Confirm the pipe diameter.

Cut the cone of the Effisus Stopper MR at the indicated position corresponding to the relevant pipe size.

### Flashing down over pipe

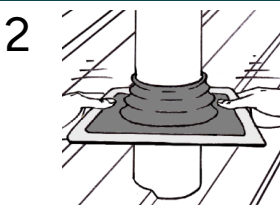

2

Slide the Effisus Stopper MR flashing down over the pipe.

Water may be used as a lubricant to facilitate sliding the Effisus Stopper MR into position.

### Positioning and marking a guideline



3

Position the Effisus Stopper MR in a 'diamond' orientation in relation to the metal roof corrugation (as shown in the image).

Using your hands, apply pressure to the base of the Effisus Stopper MR so that it follows the contours of the roof panel.

While keeping the Effisus Stopper MR in this position, use a marker to draw a line on the roof indicating the outer perimeter of the Stopper base.

### Applying the adhesive

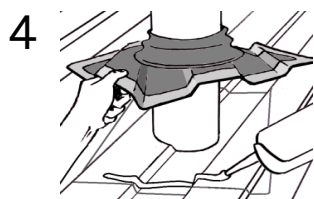

4

Lift the Effisus Stopper MR.

Apply a bead of Effisus Bonding KF+P Adhesive inside the line marked in step 3.

### Mechanically fastening

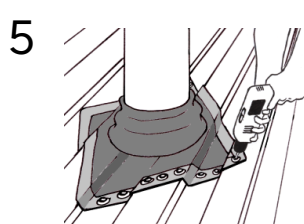

5

Slide the Effisus Stopper MR down into the intended position.

Begin fastening the Effisus Stopper MR to the roof with one screw on two opposite sides of the Stopper base.

Continue fastening the Effisus Stopper MR to the roof, ensuring that the maximum spacing between screws does not exceed 40 mm and that the fastening follows precisely the contours of the roof panel.

Apply a bead of Effisus Bonding KF+P Adhesive around the perimeter of the installed Effisus Stopper MR, both at the bottom and at the top.