

INSTALLATION AND CONSUMPTION Æ EFFISUS ECOFACADE SYSTEM

1. Summary

Effisus Ecofacade is an integrated system, efficient and sustainable, which guarantees the façade airtightness and maximizes its energy and acoustic efficiency, eliminating air transfers between indoors and outdoors. At the same time it protects the most vulnerable points in a building which are exposed to weather elements, eliminating pathologies associated to condensations.

2. Usages Scope

In general: Effisus Ecofacade System can be used for airtightness and waterproofing verification on façades and for the elimination of building pathologies associated with condensations.

Wall Lining
 Effisus Breather Membrane
 Effisus Approved Thermal Insulation
 Effisus Vap Membrane
 Wall
 Effisus Ecofacade Membrane,
 Effisus Ecofacade SA-Edge or
 Effisus Ecofacade P-Fix

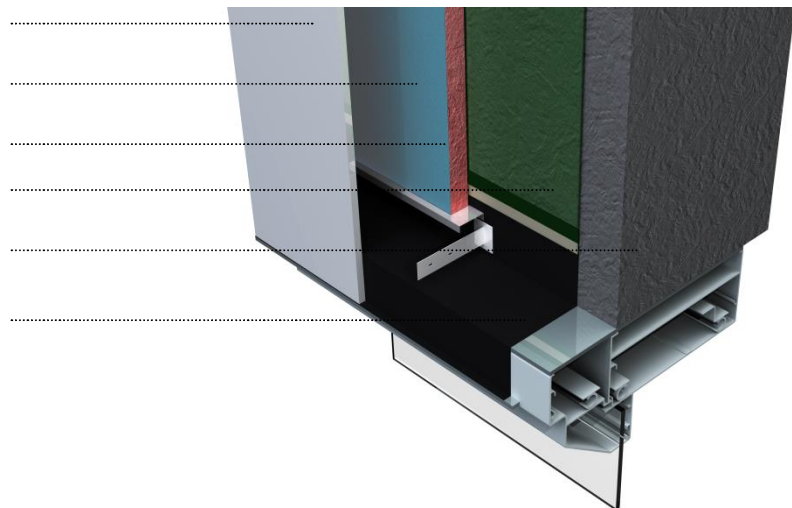

Fig. 1 Æ Effisus Ecofacade System

3. Presentation and System Details

3.1 Effisus Vap Membrane

Vapour barrier for façades and roofs.

The sd value of 100m effectively prevents the building of condensate in the areas of insulated construction. The technical characteristics of Effisus Vap Membrane allow furthermore a construction without special calculated proof of condensate safety – providing a construction according to DIN 4108.

Identification: label with product name, thickness, width and length.

Available Widths: 2.00m and 4.00 m.

Roll Length: 25m and 50m.

Colour: White.

Characteristics: see Table.

Effisus Vap Membrane		
Technical data	Test Method	Value
Material		LDPE Film (low density polyethylene)
Colour		White, 1-colour print
Thickness		200u
Sd-value		≥ 100m (DIN EN 1931:2000)
Flammability	DIN EN 13501-1	Class E
Dimensions		4m x 25m
		2m x 50m
CE Control		Pass
Tensile strength	DIN EN ISO 527-3	
	Lengthwise	≥ 17 N /mm
	Crosswise	≥ 15 N /mm
Tear resistance	DIN EN 12311-2	
	Lengthwise	≥ 170 N/50mm
	Crosswise	≥ 150 N/50mm
Elongation at break	DIN EN 12311-2	
	Lengthwise	≥ 250%
	Crosswise	≥ 400%
Tear strength	DIN EN 12340-1	
	Lengthwise	≥ 50 N
	Crosswise	≥ 50 N
Temperature range		-20°C to +80°C
Water resistance		Pass
Core diameter		76.5mm
Storage		In dry rooms from 5°C to 25°C, protected from UV radiation

3.2 Effisus Breather Membrane

Diffusion permeable and rain-proof membrane for use as a wall lining membrane.

Identification: label with product name, thickness, width and length.

Available roll width: 1.50m e 3.00m.

Roll length: 50m.

Characteristics: see Table.

Effisus Breather Membrane		
Technical data		Value
Nominal Width		1.5m or 3.0m
Nominal Length		50m
Water vapour transmission resistance	sd	Less than 0,05m
	Permeance	More than 66 US perms
	MVTR	Less than 0,25MNs/g
Superficial mass		100g/m ²
UV stability and outdoor exposure		3 months
Fire Rating		B2
Tensile strength to tear		More than 140N/5cm
Tensile strength to tear by nail		More than 120N
Service Temperature		-40°C to +100°C
Colour		Black
Roll Width		1.5m or 3.0m
Roll Length		50m
Roll Area		75m ² or 150m ²
Roll Weight		13 kg or 26 kg

3.3 Effisus Ecofacade Membranes

3.3.1 Effisus Ecofacade Membrane

Waterproofing membrane made of vulcanized EPDM rubber.

Thickness uses:

- Waterproofing as second barrier: $\geq 0.60\text{mm}$;
- Waterproofing as first barrier: $\geq 1.0\text{mm}$;
- Horizontal unprotected waterproofing: $\geq 1.30\text{mm}$.

Identification: label with product name, thickness, width and length.

Available widths: 50mm multiples between 100mm and 1300mm.

Thicknesses: 0.60 – 0.75 – 1.00 – 1.30 and 1.50mm.

Roll length: 20m.

Other widths and lengths are available if required.

Characteristics: See table.

Effisus Ecofacade Membrane		
Technical data	Norm	Value
Thickness -5% +10% (mm)	EN 1849-2	0.60 – 0.75 – 1.00 – 1.30 – 1.50
Superficial mass (g/m ²) (+/- 10%)	EN 1849-2	780 – 970 – 1250 – 1580 - 1830
Nominal length		20 or 25m
Nominal width		5cm multiples between 0.10 and 1.30m
Colour		Black
Waterproofing under water pressure	EN 1928	2 kPa
Permeability to water steam μ	EN 1931	60.000 \pm 25.000
Permeability to air (m ³ /h.m.daPa ² /3)	EN 12114	\leq 0.1
Tensile strength (N/mm) new For all thicknesses	EN 12311-2 B Method	L: \geq 4 L: \geq 6
Elongation at rupture (%) new For all thicknesses	EN 12311-2 B Method	\geq 300
Tensile strength to tear by nail (N)		
At 0.60mm		L \pm 80 D \pm 120
At 0.75mm	EN 12310-1 + EN 13859 annex B	L \pm 80 D \pm 120
At 1.00mm		L \pm 90 D \pm 150
At 1.30mm		L \pm 130 D \pm 200
At 1.50mm		L \pm 180 D \pm 270
Static penetration \ddot{E} concrete	EN 12730	L15
Dynamic penetration (mm)	En 12961: 2006	\geq 200

3.3.2 Effisus Ecofacade Membrane \ddot{E} Options

3.3.2.1 Effisus Ecofacade SA-Edge Membrane

Effisus Ecofacade Membrane with 1 or 2 self-adhesive butyl based edges.

Available widths: 50mm multiples between 100mm and 400mm.

Thicknesses: 0.60 – 0.75 – 1.00 – 1.30 and 1.50mm.

Roll length: 20m.

The width of the self-adhesive strips is dependent of the width and thickness of the membranes:

- 150mm with 20mm self-adhesive edges,
- 200, 250mm with 30mm self-adhesive edges,
- 300, 400mm with 40mm self-adhesive edges.

Over smooth surfaces the self-adhesive edges do not need gluing or additional fixing.

Over wet surfaces, the use of a primer will be required before bonding.

3.2.2 Effisus Ecofacade P-Fix Membrane

Effisus Ecofacade Membrane with 1 or 2 fitting profiles for facade / framework profiles.

Available widths: 50mm multiples between 100mm and 600mm.

Thicknesses: 0.75 – 1.00 – 1.30 and 1.50mm.

Roll length: 20m.

The fitting profile adapted to the groove of the facade / framework profiles does not require gluing or additional fixing.

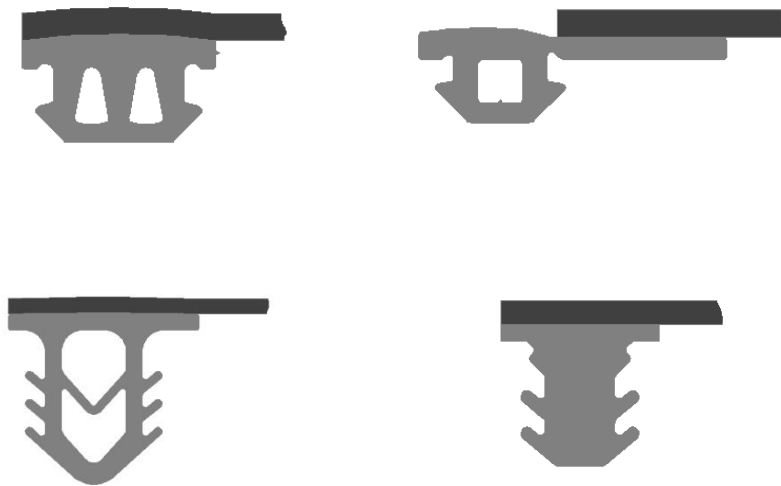

Figs. 2A, 2B, 2C, 2D - Fitting profile

3.2.3 Standard and pre-fabricated elements

The pre-fabricated elements of Effisus Ecofacade Membranes allow a simple and rational waterproofing of all critical points, such as:

- top corners,
- very lengthy connections,
- exterior and interior corners, water exits, etc., cut-to-size elements.

These elements allow a preliminary assembly regardless of the weather conditions. The pre-fabricated elements can be mechanically fixed, fixed by fitting, or glued to the frame profile.

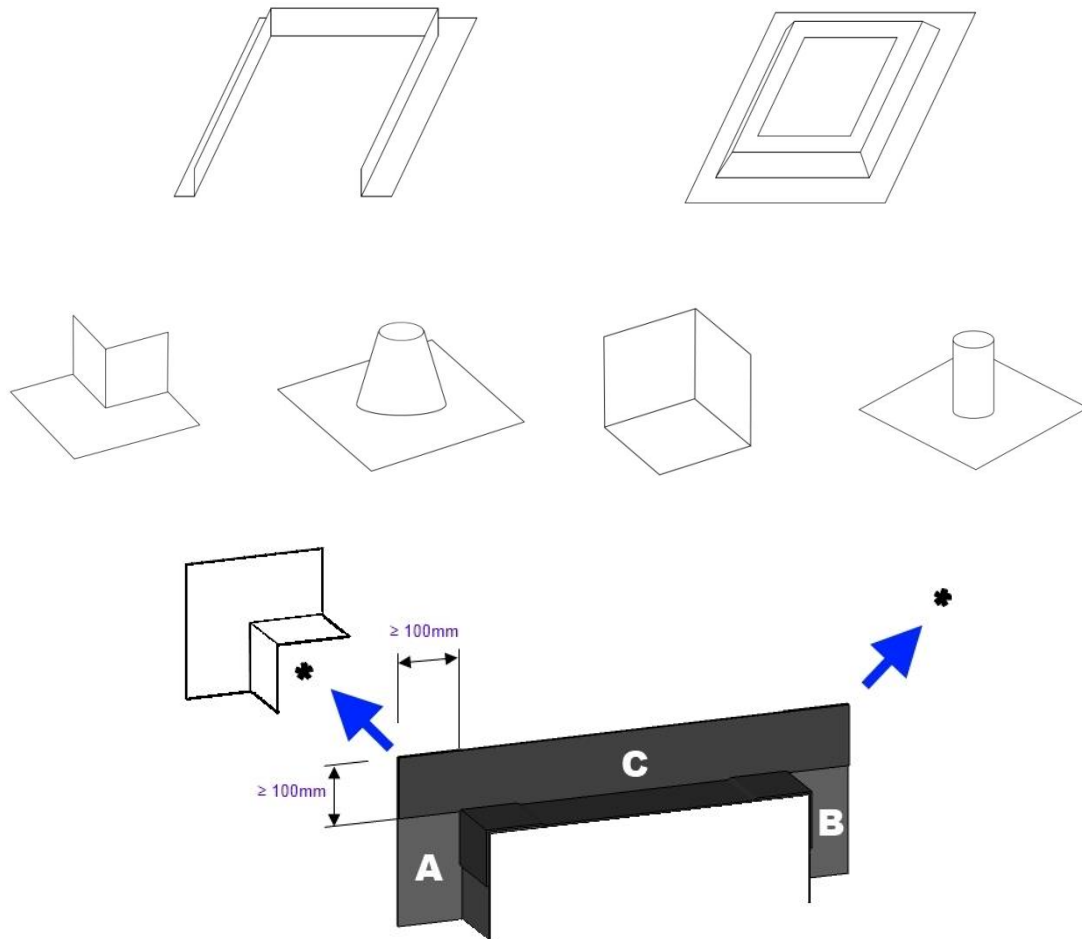

Fig. 3 - Pre-fabricated elements and standard elements

3.2.4 Effisus Ecofacade Inside Membrane

The Effisus Ecofacade Inside Membrane has a lower water vapour permeability, being suitable to be used on the interior of the thermal insulation.

Its dimensions (thicknesses (the 0.60mm thickness does not exist), widths and lengths) are the same as Effisus Ecofacade Membranes.

The water vapour diffusion resistance factor of Effisus Ecofacade Inside Membrane is approximately 3 times higher than the one of the Effisus Ecofacade Membrane.

Identification: label with product name, thickness, width and length.

The membrane surface is textured and it has an identifiable printing.

The bonding accessories are the same as of the Effisus Ecofacade Membrane.

4. Accessories Æ Effisus Vap Membrane

4.1 Adhesive Tapes

Adhesive tapes for Effisus Vap Membranes overlaps airtight sealing and Effisus Vap Membranes bonding to smooth, non porous substrates.

4.1.1 Effisus 2Bond GO Tape

Extruded double sided self-adhesive butyl-rubber sealant on silicone paper, without backing, multi-functional for airtightness connections.

Suitable for sealing and bonding Effisus Vap Membrane to smooth, non porous substrates.

Offers high protection against piercing due to its high elasticity.

With release paper.

Thickness: 1mm.

Width: 10mm up to 50mm.

Roll Length: 30m.

Colour: Black.

4.1.2 Effisus Adjoin GS Tape

PE sealing tape, airtight, moisture resistant and UV stabilized.

Very pliable and stretchable PE film sealing tape with a special polyacrylic adhesive of extremely high adhesion and superior ageing resistance.

Effisus Adjoin GS Tape is equipped with a polyamide fiber carrier embedded into the adhesive, which reinforces the tape and prevents over expansion during application.

For airtight bonding and sealing of overlaps, joints and penetrations of Effisus Vap Membranes according to DIN 4108 Part 7.

With release paper.

Thickness: 0.35mm.

Width: 50mm up to 150mm.

Roll Length: 25m.

Colour: Green.

4.2 Accessories Æ Effisus Breather Membrane

4.2.1 Adhesive Tapes

Adhesive tapes for airtight and moisture proof sealing of Effisus Breather Membranes overlapping.

The tapes are suitable for bonding Effisus Breather Membrane to smooth, non porous substrates.

4.2.1.1 Effisus Adjoin TI Tape

Flexible multi-purpose adhesive tape for airtight bonds.

Effisus Adjoin TI Tape is a flexible multi-purpose adhesive tape for airtight bonds indoors and outdoors in accordance with DIN 4108, SAI 180 and ÖNorm B8110-2.

Effisus Adjoin TI Tape is used to form a secure and permanent seal of overlaps between Effisus Breather Membranes and joints between such membranes and smooth, non-mineral surfaces.

Offers high protection against piercing in corners due to its high elasticity.

With release paper.

Roll Width: 60mm

Roll Length: 30m.

Colour: Black

4.2.1.2 Effisus 2Adjoin DF Tape

A double sided airtight and moisture resistant sealing tape.
Suitable for fixing all of Effisus Breather Membranes, PE/PA/PP and aluminium foils to metal studs. Suitable for windtight and moisture proof sealing of external membranes.
Quick and easy to apply using the Effisus 2Adjoin DX Hand Dispenser.
With a release paper.
Roll width: 25mm.
Roll length: 20m.
Colour: Colourless with a polypropylene reinforcement.

4.2.2 Accessories: Others

4.2.2.1 Effisus Bonding OF Adhesive

Solid acrylic glue for greater resistance to high humidity on site and durability.
Airtight bonding in accordance with DIN 4108-7, SAI 180 and ÖNorm B8110-2. Effisus Bonding OF Adhesive has exceptionally high cohesion while also being elastic. Its outstanding adhesion to building materials gives the joint the necessary safety and longevity. It is suitable for bonding Effisus Breather Membrane to other building materials regardless of smooth, rough or smooth stony surface.
Unstable or crumbling surfaces either need to be cleared from any loose particles or sanded and stabilized using Effisus Coat RP Primer.
Package: 310ml tube.

4.2.2.2 Effisus Tight Grommet

Airtight grommets made from EPDM with acrylate solvent-free adhesive tape, for a secure feed-through for cables and pipes with diameters between 6 and 200 mm. Offers high protection against piercing due to its high elasticity.
Effisus Tight Grommet feature an integrated adhesive with a release paper for easier application.

4.3 Accessories Ë Effisus Ecofacade Membrane

4.3.1 Adhesives Ë Usages of the different adhesives

Overlapping Membranes / Mineral surfaces: concrete – porous or smooth / Metals: lacquered aluminium, galvanized, zinc / PVC: PVC profiles / Wood: crude or treated, composites / Old bituminous surfaces – preform test first.
In damp surfaces: first apply a layer of Effisus Coat NP Primer.
One should always test bonding first – the bonding surface should be clean, dry and degreased.

4.3.1.1 Contact Glue - Effisus Bonding KT Adhesive

Contact glue made of synthetic rubber.
This adhesive should be used in smooth bonding surfaces. The level of unevenness should not exceed 1mm. If this is not the case, a perimeter sealing should be made with Effisus Block JP Sealant.

4.3.1.2 Adhesive Paste - Effisus Bonding KF Adhesive

Paste adhesive made of synthetic rubber.
To safely use this adhesive, the level of unevenness should not exceed 15mm.

4.3.1.3 Adhesive Paste - Effisus Bonding KF+ Adhesive

Paste Adhesive made of polyurethane with low content of solvents.

4.3.1.4 Self-adhesive Edges - Effisus SA-Edge Strips

The butyl self-adhesive edges re usually first stuck to the Effisus Ecofacade Membranes.
The self-adhesive edges width varies according to the width and thickness of the membrane: 150mm with self-adhesive edge of 20mm; 200, 250mm with self-adhesive edge of 30mm; 300, 400mm with self-adhesive edge of 40mm.
Over smooth surfaces the self adhesive edge does not require gluing or additional fixing.

4.3.2 Accessories: Primer, Cleaner and Sealant

4.3.2.1 Effisus Coat NP Primer

Primer to prepare surfaces before the bonding of the Effisus Ecofacade SA-Edge Membranes.

In porous, damp or when applying with temperatures within 5°C e -10°C, use this primer for surface treatment before the use of the adhesives Effisus Bonding KT and Effisus Bonding KF.

Using Primer Effisus Coat NP in porous and damp surfaces			
	Effisus Bonding KT Adhesive	Effisus Bonding KF Adhesive	Effisus SA-Edge Membrane
Porous surfaces			x
Highly porous surfaces	x		x
Damp surfaces	x	x	x

4.3.2.2 Effisus Setup PR Cleaner

Before applying any of the adhesive options mentioned earlier, use this product first to clean smooth surfaces.

4.3.2.3 Effisus Block JP Sealant

Sealant to seal the top and bottom of one membrane bonded with self-adhesive Effisus SA-Edge Strips.

Sealant to seal top and bottom of one membrane that was previously bonded with the Effisus Bonding KT Adhesive in overlapping joints and other trims.

5. Additional mechanical fixing

If properly used, no additional fixing is required when applying the above-mentioned adhesives, however it is advisable in the following cases:

- if the bonding width is smaller than the recommended minimum or if any thermal action is predictable to jeopardize the bonding of the Effisus Ecofacade Membrane.
- if the facade details are of difficult access, it should be anticipated the use of mechanical fixing on top of the membrane.

The mechanical fixing should be performed with aluminium termination bars fixed to the support with a 250mm maximum spacing between fixing points.

6. Production, marketing and technical solution

Up-Way Systems is the Effisus Ecofacade Membranes and Accessories supplier.

The different components are dosed, blended, its calendering and vulcanization is performed.

Under industrial control, laboratory testing of the manufactured goods is performed and continuously recorded. This control is subject to external periodic inspection.

7. Installation instructions

7.1 Installation instructions Effisus Vap Membrane

7.1.1 General Guidelines

It is the end user's responsibility to ensure the quality of the installation, by following the installation instructions in this document and by periodically checking the installed materials.

Upon request, Up-Way Systems is available to train working staff.

7.1.2 Storage

The Effisus Vap Membrane rolls and system accessories should be stored on hard, clean and dedicated stand, in a place that can protect them from extreme weather conditions, and be kept within temperatures of 5°C and 20°C.

9/18

7.1.3 Installation conditions

The Effisus Vap Membrane should be applied using the accessories recommended in this document.

The Effisus Vap Membrane should not ever be installed under stress, therefore its width should be calculated taking in consideration the predictable differential movements of the supports. The bonding should be made on dry, ungreased, clean and dust free supports.

In case of rainfall (rain, snow, intense fog and if any risk of condensation is present), the adhesive setting must be stopped.

7.1.3.1 Effisus Vap Membrane Fixing

The Effisus Vap Membrane should be secured to the metal structure using the Effisus 2Bond GO Tape, with a maximum spacing between securing lines of approx. 0.5m.

The membrane should be mechanically fixed shortly after.

7.1.3.2 Overlapping Joints

Horizontal joints should overlap by 100mm minimum. Vertical joints should overlap by 150mm minimum and be staggered or offset wherever possible.

Joints should be sealed with Effisus Adjoin GS Tape.

7.1.3.3 Other Details

Any penetration of the Effisus Vap Membrane with metal profiles, cables or pipes should be sealed using the Effisus Adjoin GS Tape.

7.2 Installation instructions Effisus Breather Membrane

7.2.1 General Guidelines

It is the end user's responsibility to ensure the quality of the installation, by following the installation instructions in this document and by periodically checking the installed materials.

Upon request, Up-Way Systems is available to train working staff.

7.2.2 Storage

The Effisus Breather Membrane rolls and system accessories should be stored on hard, clean and dedicated stand, in a place that can protect them from extreme weather conditions, and be kept within temperatures of 5°C and 20°C.

7.2.3 Installation conditions

The Effisus Breather Membrane should be applied using the accessories recommended in this document.

The bonding should be made on dry, ungreased, clean and dust free supports.

In case of rainfall (rain, snow, intense fog and if any risk of condensation is present), the adhesive setting must be stopped.

Upper membranes should always overlap lower membranes to allow the regular water flow.

7.2.3.1 Effisus Breather Membrane Fixing

Effisus Breather Membrane should be secured to the insulation or metal structure using the Effisus 2Adjoin DF Tape, with a maximum spacing between securing lines of approx. 0.5m.

The membrane should be mechanically fixed shortly.

Upper layers should always overlap lower layers to facilitate the easier shedding of rain.

7.2.3.2 Overlapping Joints

Upper layers should always overlap lower layers to facilitate the easier shedding of rain. Horizontal joints should overlap by 100mm minimum. Vertical joints should overlap by 150mm minimum and be staggered or offset wherever possible. Joints should be sealed with Effisus Adjoin TI Tape or Effisus 2Adjoin DF Tape (if invisible joints are required).



Fig. 4 Æ Effisus Breather Membrane Æ Overlapping Joints

7.3 . Installation instructions Æ Effisus Ecofacade Membrane

7.3.1 General Guidelines

It is the end user's responsibility to ensure the quality of the installation, by following the installation instructions in this document and by periodically checking the installed materials. Upon request, Up-Way Systems is available to train working staff.

7.3.2 Storage

The Effisus Ecofacade Membrane rolls and system accessories should be stored on hard, clean and dedicated stand, in a place that can protect them from extreme weather conditions, and be kept within temperatures of 5°C and 20°C.

7.3.3 Installation conditions

The Effisus Ecofacade Membrane should not ever be installed under stress, therefore its width should be calculated taking in consideration the predictable differential movements of the support.

The bonding should be made on dry, ungreased, clean and dust free supports.

Prevent any contact of the Effisus Ecofacade Membranes with greasy products or oils.

In case of rainfall (rain, snow, intense fog and if any risk of condensation is present), the adhesive setting must be stopped.

Over iced surfaces, or in case of temperatures below -10°C, bonding is not allowed. For temperatures between -10°C and 5°C, Effisus Coat NP Primer must be used.

Superior membranes should always overlap inferior membranes, so to allow the regular water flow.

7.3.3.1 Waterproofing in facades and windows over different supports

The Membrane should be bonded to the support surface using the Effisus Bonding KT Adhesive, Effisus Bonding KF Adhesive, Effisus Bonding KF+ Adhesive or the self-adhesive Effisus SA-Edge Strips.

7.3.3.2 Bonding using Effisus Bonding KT Adhesive

Effisus Bonding KT Adhesive should be applied on both bonding surfaces (support surface and membrane), with a minimum width of 40mm, complying with the minimum width, and in accordance with the widths and thicknesses specified in “Bonding Widths” (see table at item 7.2.3 in this data sheet).

The adhesive must dry off until it reaches the point when by touching it with the finger it no longer creates strings (there is no transmission of material between the finger and the surface). The average drying time at 20°C and 50% Relative Humidity: 10 minutes.

Apply membrane over the support and apply pressure with the help of a steel roll.

It will be difficult to make corrections to the membrane’s position and thus should be avoided.

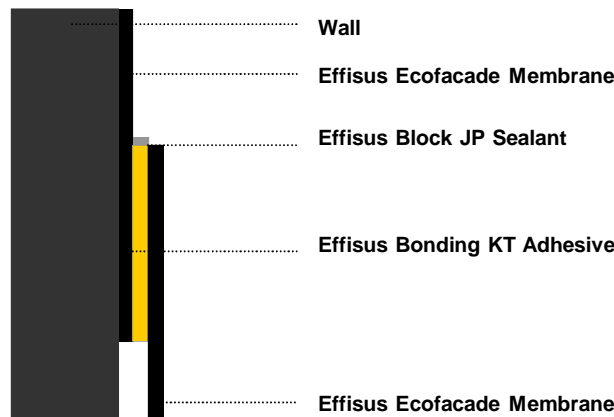

Fig. 5 Æ Bonding using Effisus Bonding KT Adhesive

7.3.3.3 Bonding when using Effisus Bonding KF Adhesive / Effisus Bonding KF+ Adhesive

The Effisus Bonding KF Adhesive is a paste / gluing mastic to be applied with a gun; the number of adhesive strings to lay down depends on the width and thickness of the Effisus Ecofacade Membrane.

The absolute minimum is of 1 line with 8 to 10mm in diameter that, when crushed, forms a gluing band with approximately 4cm wide (to confirm minimum gluing widths: see table at item 7.2.3 in this data sheet).

After applying the Effisus Bonding KF Adhesive / Effisus Bonding KF+ Adhesive on the support, directly apply the Effisus Ecofacade Membrane over the surface and apply pressure over the whole bonding area with a steel roll.

It is possible and easy to correct the membrane’s position.

The bonding strength will progressively increase until the moment when all the solvents in the adhesive fully evaporate, which can take from 10 to 14 days.

When exposed to UV’s the Effisus Bonding KF Adhesive may suffer discoloration.

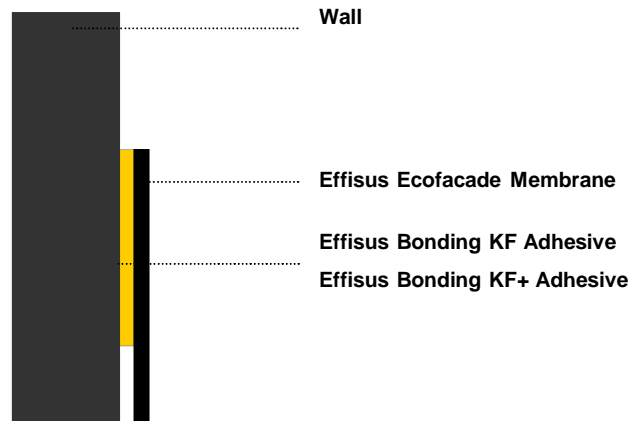

Fig. 6 – Bonding with Effisus Bonding KF Adhesive / Effisus Bonding KF+ Adhesive

7.3.3.4 Bonding Self-Adhesive Effisus SA-Edge Strips

Smooth, clean, and non absorbent support surfaces do not require previous treatment. They should only be ungreased with Effisus Setup PR Cleaner.

Porous and absorbent supports should be previously treated with Effisus Coat NP Primer.

Cut the Effisus Ecofacade SA-Edge membrane with the suitable length. Remove the self adhesive band's protection, step by step, as one progresses with the bonding and presses the membrane against the support, in the right position.

Bonding with self-adhesive Effisus SA-Edge Strips does not require any additional gluing. On the facade highest part, a sealing can be used by applying Effisus Block JP Sealant and a mechanical fixing.

It will be difficult to make corrections to the membrane's position and thus should be avoided.

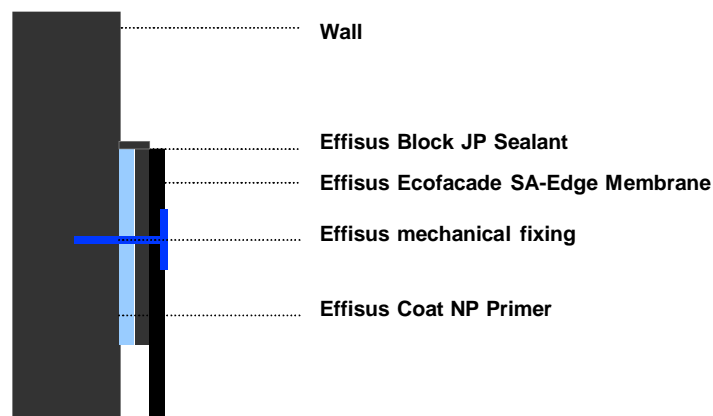

Fig. 6.1 – The facade top, in special situations where it is difficult to remove the exterior coating.

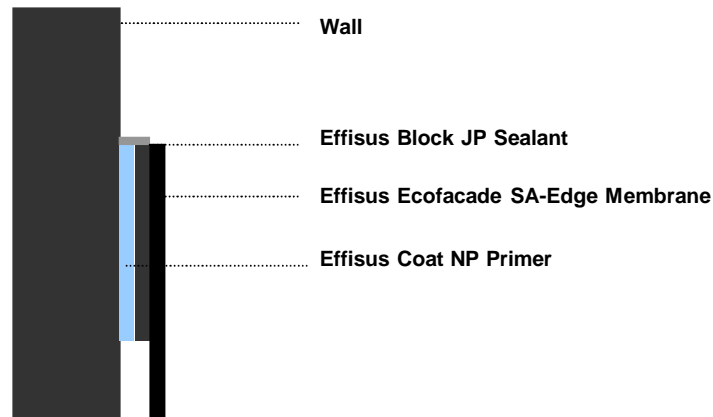

Fig. 6.2 – The facade top, in special situations where bonding surface is easily reachable.

Bonding widths over the support: Membrane thickness: 0.60 – 0.75 – 1.00mm		
	Effisus Bonding KT Adhesive	Effisus Bonding KF/ KF+ Adhesive
Membrane Width	Application width of the Effisus Bonding KT Adhesive	Number of Strings* of Effisus Bonding KF/ KF+ Adhesive
100 – 250mm	40mm	1
250 – 500mm	40 – 80mm	1 – 2
500 – 1300mm	80 – 120mm	2 – 3
Bonding widths over the support: Membrane thickness: 1.30 – 1.50mm		
	Effisus Bonding KT Adhesive	Effisus Bonding KF/ KF+ Adhesive
Membrane Width	Application width of the Effisus Bonding KT Adhesive	Number of Strings* of Effisus Bonding KF/ KF+ Adhesive
100 – 200mm	40mm	1
200 – 400mm	40 – 80mm	1 - 2
400 – 1300mm	80 – 120mm	2 - 3

* Strings with 8 to 10mm diameter to provide a bonding surface, after crushing, of ± 40mm.

7.3.3.5 Effisus Ecofacade P-Fix Membrane connections with aluminium or PVC profiles.

The Effisus Ecofacade P-Fix Membranes should be used with compatible profiles that match the aluminium / PVC profiles.

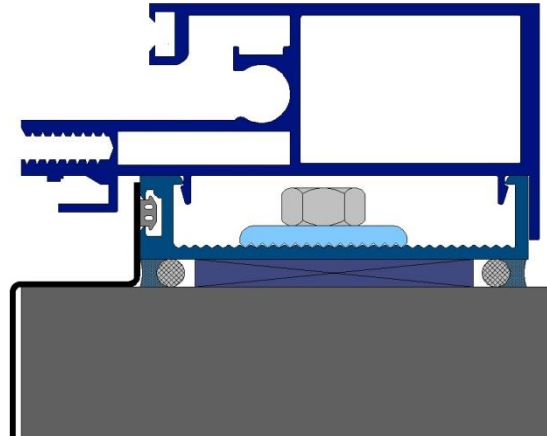

Fig. 7 Ę Connection of the Effisus Ecofacade P-Fix Membrane with profile

7.3.4 Overlapping Joints

The membranes must overlap, without any stress. The overlapping minimum is of 80mm. The membrane should have a relaxing period of at least 30 minutes.

7.3.4.1 Overlapping joints with Effisus Bonding KT Adhesive

The binding should be done applying the Effisus Bonding KT Adhesive at the ratio of 1250g/m² of joint over both faces to be bond (minimum overlapping is of 8cm). As soon as the adhesive is dry, bind both faces of the membranes and apply steady pressure. Depending on weather conditions, drying time goes from 15 to 30 minutes.

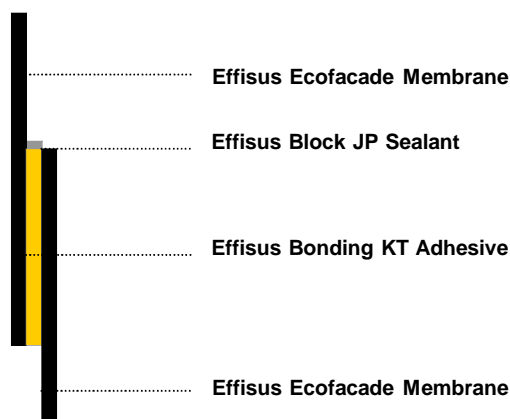

Fig. 8 Ę Overlapping joint with Effisus Bonding KT Adhesive

7.3.4.2 Overlapping joints with Effisus Bonding KF Adhesive

To perform an overlapping bonding of two Effisus Ecofacade Membranes with the Effisus Bonding KF Adhesive / Effisus Bonding KF+ Adhesive, the overlap should have at least a 8cm.
 Apply 2 strings of Effisus Bonding KF / KF+ Adhesive over the inferior Effisus Ecofacade Membrane. Overlap the superior Effisus Ecofacade Membrane and apply steady pressure.

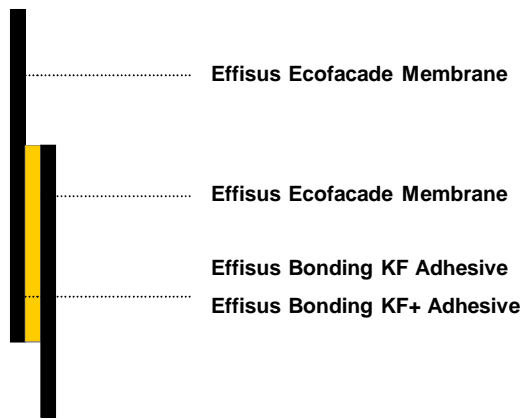

Fig. 9 Æ Overlapping joint with Effisus Bonding KF Adhesive / Effisus Bonding KF+ Adhesive

7.3.4.3 Overlapping joints with self-adhesive strips - Effisus SA-Edge Strips

Detach the protective film from the self adhesive strip. Apply the superior membrane over the self adhesive strip and apply steady pressure.

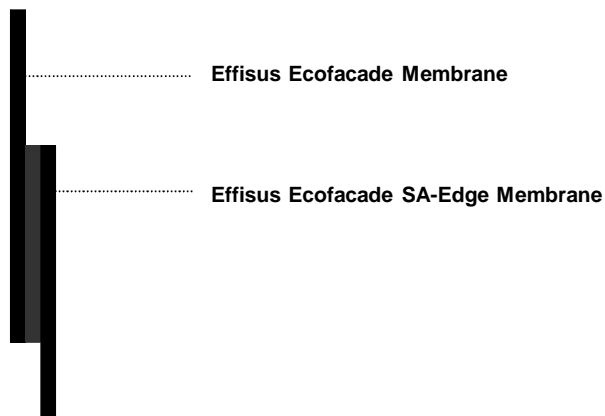

Fig. 10 Æ Overlapping joint with Effisus SA-Edge Strips

7.4 Bonds between different Effisus Membranes

7.4.1 Bonds Effisus Vap Membrane Æ Effisus Ecofacade Breather Membrane

The bonding between an Effisus Vap Membrane and an Effisus Ecofacade Breather Membrane could be done using Effisus 2Bond GO Tape or Effisus Adjoin TO Tape.

7.4.2 Bonds Effisus Vap Membrane Æ Effisus Ecofacade Membrane

The bonding between an Effisus Vap Membrane and an Effisus Ecofacade Membrane could be done using Effisus 2Bond GO Tape.

7.4.3 Bond between Effisus Ecofacade Breather Membrane Æ Effisus Ecofacade Membrane

The bonding between an Effisus Ecofacade Breather Membrane and an Effisus Ecofacade Membrane could be done using Effisus Bonding KF Adhesive.

8. Repairs

Any repairing should be made using Effisus Ecofacade System Membranes and system accessories, under Up-Way Systems approval.

9. Compatibility

The Effisus Ecofacade System Membranes are compatible with the materials using in classical construction, however, if in doubt perform a compatibility test and consult with Up-Way Systems.

The possibility of installing these materials over a waterproof bituminous membrane must be controlled and Up-Way Systems must be consulted.

Every time that Effisus Ecofacade System Membranes are to be used in aggressive atmospheres (ateliers, laboratories, ...) Up-Way Systems must be consulted.

10. Accessories Consumption

Accessories Consumption				
Product	Colour	Delivery	Consumption	Storage
Effisus Coat NP Primer	Black	4,5kg Can	At an application width of 5cm: 10-15g/m, depending on substrate	Cool, dry, frost-proof, protect from direct sunlight. Keep container tightly closed.
Effisus Setup PR Cleaner	Clear	1l Can 5l Can	35m ² /litre	Cool, dry, frost-proof, protect from direct sunlight. Keep container tightly closed.
Effisus Bonding KT Adhesive	Black	4,5Kg Can	400-500g/m ² depending on substrate. At a bonding width of 8cm approx. 50g/m	Cool, dry, frost-proof, protect from direct sunlight. Keep container tightly closed.
Effisus Bonding KF Adhesive	Black	600ml Billet	At a bonding width of 8cm approx. 100g/m, 600ml allow for a 7m bond with a width of 8cm	Cool, dry, frost-proof, protect from direct sunlight. Keep container tightly closed.
Effisus Block JP Sealant	Black	310ml Tube	15ml/tube	Cool, dry, frost-proof, protect from direct sunlight. Keep container tightly closed.

11. Test Results and Certification

The technical details are presented in this document. Results from detaching tests will be made available upon request. All the details presented were obtained from internal and external laboratories. Details from the Effisus Ecofacade System Membranes were obtained in accordance with the norms: EN 1849-2, EN 1928, EN 1931, EN 12311-2 B-Method, EN 12114, EN 12961:2006, EN 12730. All the products also have EC certification if required. For further information contact Up-Way Systems.

Version

V 1.13 – AP – 15/05/2014

18/18