

EFFISUS

EFFICIENT
SUSTAINABILITY

Críochfort
Terminal 2

Effisus product catalogue

Excellence in Weatherproofing Solutions

Table of contents

- 2. Company profile and Effisus - Efficient Sustainability
- 4. Effisus projects around the world
- 7. Effisus facade solutions
- 17. Effisus roofing solutions
- 22. Innovative outperforming solutions
- 35. Consulting
- 36. Projects portfolio
- 49. Contacts

Company profile and Effisus – Efficient Sustainability

The Effisus solutions combine, in an innovative and balanced way, Efficiency and Sustainability, promoting integrated systems with high added value and superior quality. Effisus provides “Building Envelope” solutions (water, air, heat, light and noise) to maximize performance and lifetime of buildings. Supported by our extensive consulting services, we offer a wide range of solutions and systems for roofs, facades, interiors and foundations.

We aim to lead the development and trading of sustainable and efficient solutions for the construction industry, by investing in long-term strategic partnerships with global reference partners.

The development of such partnerships is the core priority of Up-Way’s strategic business development. More than an option, it is our way of doing business and it is reflected in our daily operations.

Efficiency

- Maximum performance
- “Cutting edge technology”
- Superior quality integrated solutions
- Optimized project-centred solutions
- Guaranteed quality of installation
- Building performance optimization
- Long-term strategic vision

Sustainability

- Maximum durability
- Use of recycled and/or reusable materials
- Promoting solutions free of harmful chemicals
- Rational use of natural, technological and financial resources
- Optimization of building’s environmental performance
- Long-term strategic vision

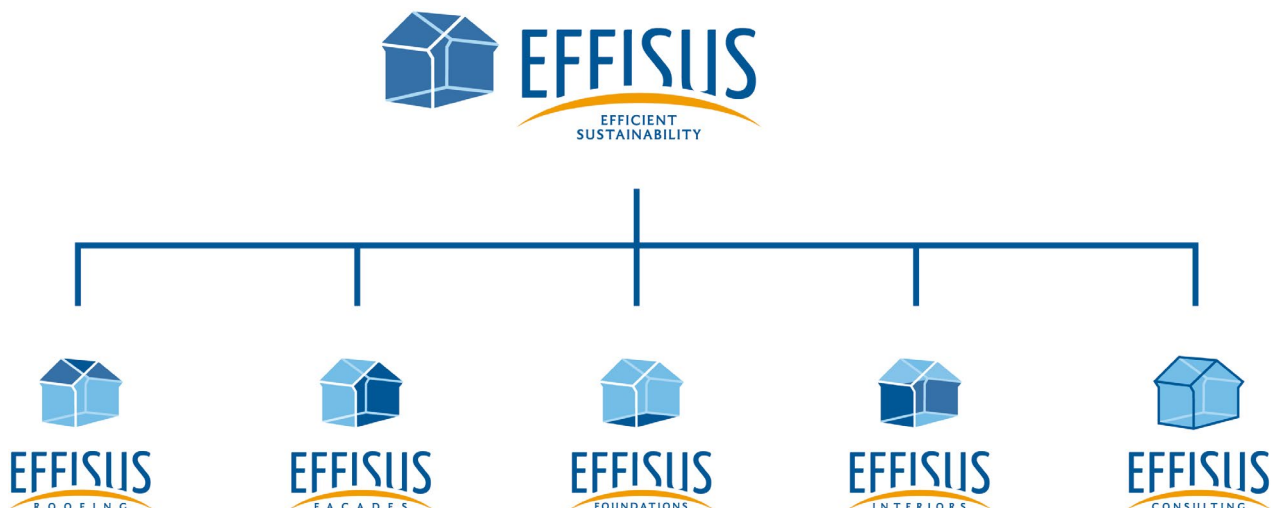

Company profile and Effisus – Efficient Sustainability

Effisus – Efficient Sustainability it is part of Up-Way Systems. Up-Way Systems develops and markets Effisus Solutions worldwide. The Effisus solutions combine in an innovative and balanced way, Efficiency and Sustainability, promoting integrated systems with high added value and superior quality.



Roof and facade integrated solutions for sealing, waterproofing, thermal and acoustic insulation that will generate superior building energy efficiency. We offer a wide range of solutions and systems for roofs and facades, supported by our extensive consulting services.

Part of a global network with more than 8000 weatherproofing experts across USA, Europe, Africa and Middle East, we aim to lead the development and commercialization of sustainable and efficient solutions for the construction industry, investing in long-term strategic partnerships with global reference partners.



The result of such partnerships is the presence of Effisus in different continents, and its participation in globally renowned projects, such as the Dublin International Airport, the Glasgow Arena in Scotland, the Orleans and Beauvais Hospitals in France, the Masdar City, Fountain Views, Skyview and the Four Seasons Hotel in Abu Dhabi.

Our mission:

We strive to provide excellence in weatherproofing solutions for the building construction segment, with a key focus on optimizing to the needs of each project. We aim to leverage strong partnerships in order to achieve efficient sustainability from start to finish. We will eagerly get involved and be proud of what we do.

Our vision:

We aim to be the first option for weatherproofing solutions on every targeted, high-end project.



Effisus projects around the world

We aim to lead the development of efficient and sustainable solutions for the construction industry, investing in long-term strategic partnerships with global reference partners.

As a result of long-term alliances with global reference partners, Effisus is present in different continents and in world leading projects.



Fountain Views

Four Seasons Abu Dhabi

SSE Hydro Arena – Scotland

Dublin Airport, Terminal 2 – Ireland

Masdar Headquarters

Stade de Lille

Hotel citizenM Paris

Hotel Myriad

Zaragoza Exposition Centre

Diagonal Zero Zero – Barcelona

Luanda Arena

King Abdullah Sports City



Effisus solutions



in



Facade solutions



Effisus Ecofacade



Effisus Ecofacade Braze



Effisus Ecofacade
Envelope



Effisus Ecork Facade

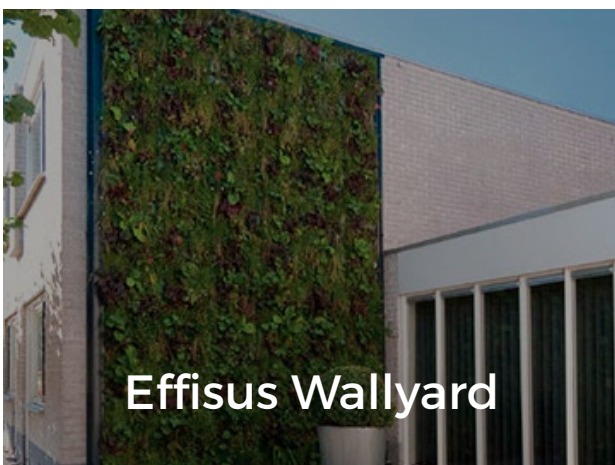

Effisus Wallyard



Effisus Ecofacade

Facade waterproofing system

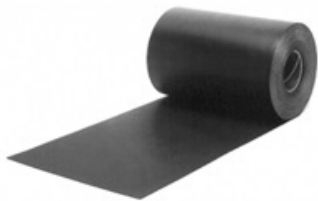

Effisus Ecofacade

Effisus Ecofacade is the integrated solution to ensure water and air tightness of all facade elements connections. Protects the building from potential water damage, maximizing energy efficiency and acoustics.

Based on a completely impermeable Effisus Ecofacade membrane with a 50 years expectable durability. With an elongation of up to 300%, it keeps its elasticity between -40°C and + 140°C, absorbing movements of thermal or structural origin of the building. Together with the system accessories it is the ideal solution for sealing all kinds of elements connections in facades.



Effisus Ecofacade SA-Edge



Effisus Ecofacade P-Fix

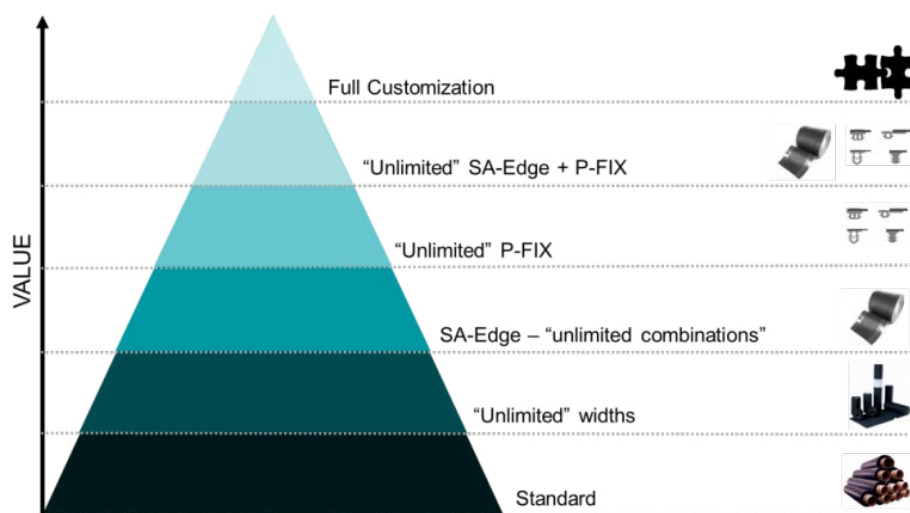

Effisus Ecofacade system can be 100% customised to your project , enhancing speed and ease of application as well reducing waste disposal and error possibility on site. All of this resulting in high earnings of productivity and consequent profitability increase.

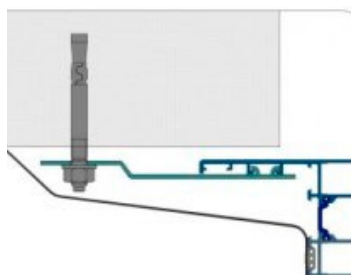

Effisus Ecofacade SA- Edge + P-Fix



Connections between Façade Elements

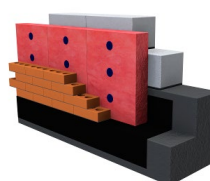

Building Foundations

A 100% customised facade interfaces' sealing solution. Productivity centred.



Effisus Ecofacade Membrane

Facade waterproofing system

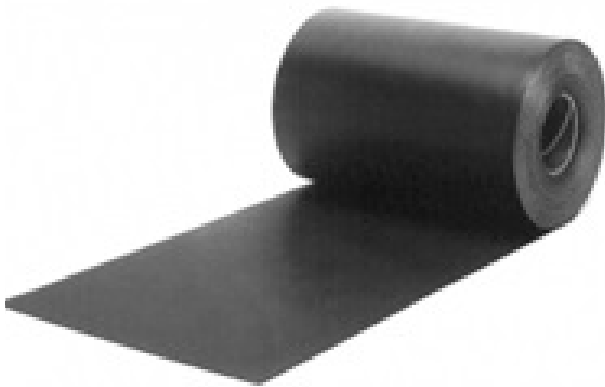

Effisus Ecofacade

inner-shell, from the action of atmospheric agents and their consequences. It ensures both water and air tightness, whilst also maximizing energy efficiency and acoustics.

Effisus Ecofacade is the definite system for waterproofing facades. The system's high performance and added value are guaranteed, not only due to its temperature range resistance, but also to its possibility of full customisation, according to each specific project. Through this, the system's ease and speed of application are increased, the possibility of errors during installation are reduced and waste materials are minified.

The system protects buildings' facade connections, and consequently its entire

Effisus Ecofacade:

- Fully customisable widths
- Expectable durability of 50 years
- Resistant to UVs and ozone
- Service temperatures from -30°C e +140°C
- Permanently elastic
- Possibility of integrated self-adhesive bands or fast connect gaskets for no need of extra accessories
- Elongation of up to 300%
- Both thermal and structural vibration resistance
- Possible last-minute orders

Typical Applications:

- Connections in ventilated facades
- Connections in curtain walls
- Connections in traditional facades
- Connections in pre-fabricated facades
- Sustainable Construction Projects



Solution benefits

- Robust – 100% waterproof and UV resistant
- Universal – Customisable dimensions
- Durable – High life-expectancy
- Flexible – Option for integrated self-adhesive bands and/or fast-connect gaskets
- Easy to apply – Simple to handle materials and no need for accessories

-Brochure

-Data sheet

-MSDS

-Efficiency

-Applications

-Installation



Effisus Ecofacade SA-Edge

Facade connections waterproofing system with self-adhesive bands



Effisus Ecofacade SA-Edge

Effisus Ecofacade SA-Edge is the innovative time-saving system for waterproofing facade connections. The system's high performance and added value are guaranteed, not only due to its expectable durability of over 50 years, but even more to its self-adhesive bands, which can be of any number and configuration, according to each project's needs. Through the extinction of the need for adhesive pastes, applications' ease and speed are increased, wastes are eliminated and budget predictability is more effective.

Possibility of human error during installation is widely reduced.

The system protects buildings' facades at their weakest points – connections. It protects them from the degrading action of atmospheric agents, such as oxidation and mould. This is done by ensuring both water and air tightness, which also improves energy efficiency and acoustics.

Effisus Ecofacade SA-Edge:

- Fully customisable widths
- Expectable durability of 50 years
- Resistant to UVs and ozone
- Service temperatures from -30°C e +140°C
- Permanently elastic
- Elongation of up to 300%
- Both thermal and structural vibration resistance
- Possibility of having multiple self-adhesive bands and custom positions
- Possibility of last-minute orders



Effisus Ecofacade SA-Edge

Typical Applications:

- Connections in ventilated facades
- Connections in curtain walls
- Connections in traditional facades
- Connections in pre-fabricated facades
- Sustainable Construction Projects

Solution benefits

- Robust – 100% waterproof and UV resistant
- Universal – Customisable dimensions
- Durable – High life-expectancy
- Flexible – Customisable integrated self-adhesive bands
- Easy to apply – Simple to handle materials and no need for accessories

-Brochure

-Data sheet

-MSDS

-Efficiency

-Applications

-Installation



Effisus Ecofacade P-Fix

Facade connections waterproofing system with fast-connect gaskets



Effisus Ecofacade P-Fix

Effisus Ecofacade P-Fix is the leading system for waterproofing facade connections. The system's efficiency and added-value are guaranteed, not only due to its service temperatures or durability, but especially due to its fast-connect vulcanized gaskets. These can be customised to fit any framework, thus providing an unprecedented speed and ease of application, in junction with unrivalled protection and durability.

The system protects buildings' facade connections from the deteriorating effects of atmospheric agents, and is both waste and error free during installation. At the same time it maximizes energy efficiency, improves acoustics, and appreciates buildings' value. Finally, the system has an unbeatable productivity during installation and service life, since one can easily remove the gasket for maintenance and inspection.

Effisus Ecofacade P-Fix:

- Fully customisable widths
- Expectable durability of 50 years
- Resistant to UVs and ozone
- Service temperatures from -30°C e +140°C
- Permanently elastic
- Elongation of up to 300%
- Possibility of developing your own gasket
- Both thermal and structural vibration resistance
- Customisable gaskets according to each project's needs



Typical Applications

- Connections in ventilated facades
- Connections in curtain walls
- Connections in traditional facades
- Connections in pre-fabricated facades
- Sustainable construction projects
-



Solution benefits

- Robust – 100% waterproof and UV resistant
- Universal – Customisable dimensions
- Durable – High life-expectancy
- Flexible – Customisable fast-connect gaskets
- Easy to apply – Simple to handle materials and no need for accessories

-Brochure

-Data sheet

-MSDS

-Efficiency

-Applications

-Installation

in



Effisus Ecofacade Pre-fab Corners

Pre-fabricated corners for facade connections waterproofing



Effisus Ecofacade Pre-fab Corners

Effisus Ecofacade Pre-fab Corners are the ultimate supplement for a fast and error-free Effisus Ecofacade System installation. When waterproofing facade connections, corners are the hardest points to seal, due to the need of cutting the waterproofing membranes, creating overlaps using sealants. Effisus Pre-fab Corners are custom-made to the needs of each situation, which not only enormously increases efficiency during application, but also improves the whole system's efficiency. Through this, the most vulnerable areas are transformed into the safest ones.

Effisus Ecoface Pre-fab corners, together with the Ecofacade System, provide the ultimate, efficient and sustainable, façade waterproofing. Not only do they increase the speed of a critical, but time-consuming job – Efficiency – but also, immensely, reduce the amount of wastes and boost service life-time – Sustainability.

Effisus Ecofacade Pre-fab Corners:

- Fully customisable dimensions and configurations
- Expectable durability of 50 years
- Resistant to UVs and ozone
- Service temperatures from -30°C e +140°C
- Permanently elastic
- Elongation of up to 300%
- Both thermal and structural vibration resistance
- Variants for internal and external application



Typical Applications

- Connections in ventilated facades
- Connections in curtain walls
- Connections in traditional facades
- Connections in pre-fabricated facades
- Sustainable construction projects

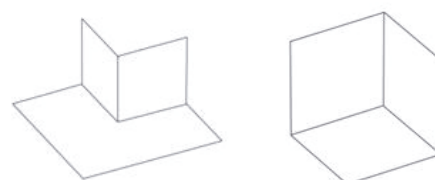

Solution benefits

- Robust – 100% waterproof and UV resistant
- Universal – Customisable dimensions and configurations
- Durable – High life-expectancy
- Flexible – Absorbs structural movements
- Easy to apply – Simple to handle materials and no need for accessories

-Brochure

-Data sheet

-MSDS

-Efficiency

-Applications

-Installation



Effisus Ecofacade Pre-fab Frames

Pre-fabricated frames for window waterproofing

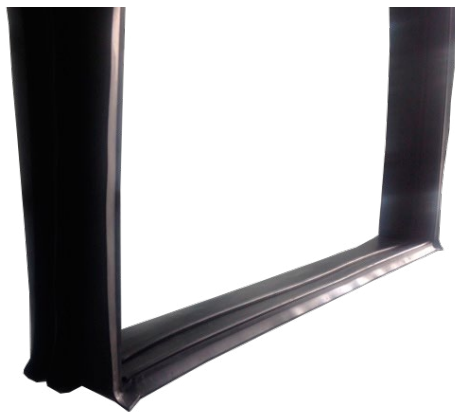

Effisus Ecofacade Pre-fab Frames

Effisus Ecofacade Pre-fab Frames are the outperforming system for a seamless facade-to-window connection sealing job. Due to their edges and shape, sealing window frames has always required a large amount of time, wastes and sealants, but not anymore. Since the frames are customised and pre-fabricated according to the windows' frames, using Ecofacade Membrane, a time-saving, error-free, long-lasting installation is assured.

With Effisus Ecofacade Pre-fab Frames, waterproofing windows becomes an efficient and sustainable job. Not only is time saved, but also, the probability of installation errors is eliminated, needed labour is reduced and performance is better assured than ever.

Effisus Ecofacade Pre-fab Frames:

- Fully customisable dimensions and configurations
- Expectable durability of 50 years
- Resistant to UVs and ozone
- Service temperatures from -30°C e +140°C
- Permanently elastic
- Elongation of up to 300%
- Both thermal and structural vibration resistance
- In-factory pre-fabrication and vulcanisation

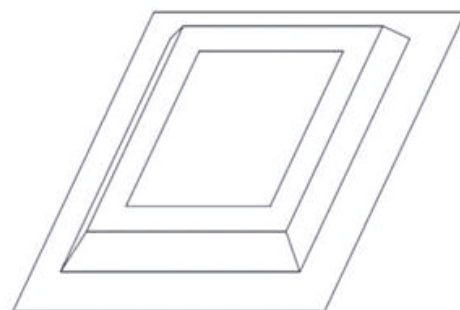

Typical Applications

- Connections in ventilated facades
- Connections in curtain walls
- Connections in traditional facades
- Connections in pre-fabricated facades
- Sustainable construction projects

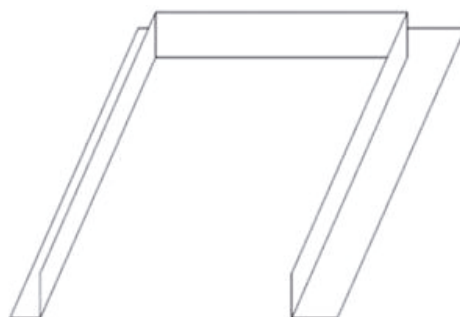

Solution benefits

- Robust – 100% waterproof and UV resistant
- Universal – Customisable dimensions and configurations
- Durable – High life-expectancy
- Flexible – Absorbs thermal dilation/contraction and structural movements
- Easy to apply – Simple to handle materials and no need for accessories

-Brochure

-Data sheet

-MSDS

-Efficiency

-Applications

-Installation

in



You
Tube



Effisus Ecofacade Braze

Facade waterproofing system with superior fire resistance



Effisus Ecofacade Braze

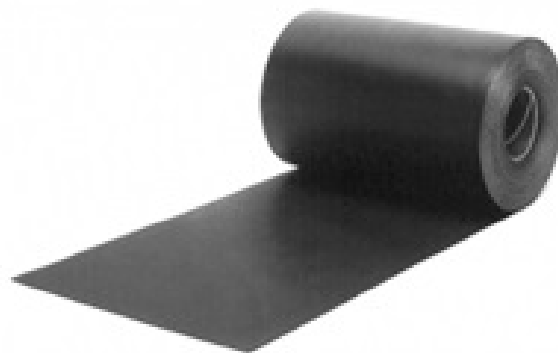

Effisus Ecofacade Braze

The Effisus Braze system ensures water tightness of the facade, guaranteeing proper water vapour management whilst having superior fire resistance. Effisus Braze eliminates the possibility of condensation and conditions associated with moisture, maximizing energy efficiency and acoustics. Indoor air quality and health of users is also promoted.

It is an integrated, efficient and sustainable system that protects the building from atmospheric elements. It's the best solution for buildings with the highest requirements for fire action resistance.

Efficiency

- Complete and integrated system
- "Cutting Edge technology"
- Excellent thermal and acoustic insulation properties
- Waterproofing solutions with intelligent facade water vapour management
- Unique thermal delay properties
- Technical support from design to construction
- Excellent puncture and tear resistance
- Excellent resistance to UV's and high temperature ranges
- Excellent chemical compatibility and resistance to microbiological attack

Sustainability

- Elevated longevity
- Promotes indoor air quality and users' health
- 100% natural and recyclable insulation
- High product life-expectancy
- Reduced maintenance needs
- "Energy Star certification"
- Without chlorides, halogens or other harmful chemicals to the environment
- Low energy consumption in the production, installation and use
- Optional gasket system with no need of adhesives
- Reduced wastes through solution customization

**The most sustainable solution for facade and building protection.
Improved air quality and users' health.**

-Brochure

-Data sheet

-MSDS

-Efficiency

-Applications

-Installation



Effisus Ecofacade Envelope

Air tightness and water vapour management facade integrated system

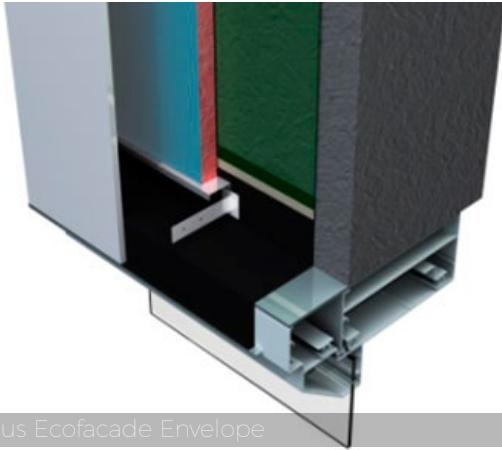

Effisus Ecofacade Envelope

The Effisus Ecofacade Envelope system ensures facade air and water tightness, while ensuring proper management of water vapour. It eliminates the possibility of condensation and conditions associated with moisture, maximizing energy efficiency and acoustics.

It's an Efficient and sustainable integrated system, which functions as an unit, eliminating the possibility of condensation on the inside of the facade, thereby promoting the quality of indoor air and protecting building users health.



Effisus Ecofacade EPDM Waterproofing Membrane

Efficiency

- Complete and integrated system
- "Cutting Edge technology"
- High elongation capabilities: absorbs the building movements from thermal or structural origin
- Watertight and intelligent water vapour management
- Adaptable solutions to the requirements of each project
- Ongoing technical support in all phases of the project
- Easy and quick installation

Sustainability

- High impact on the lifetime of the building
- Promotes indoor air quality and building user's health
- Reduced maintenance requirements
- Recyclable membranes
- Solvent-free accessories
- Quick-connection system option with no need for adhesives or tapes
- Waste reduction by customizing solutions



Effisus VAP Vapour Barrier

Typical Applications

- Ventilated facades
- Curtain walls
- Traditional facades
- Prefabricated facades
- Sustainable construction



Effisus Breather+ Breathable Membrane

Facade and building protection, improved indoor air quality and user's health.

-Brochure

-Data sheet

-MSDS

-Efficiency

-Applications

-Installation



Effisus Ecork Facade

Airtightness and water vapour management integrated system for facades with cork insulation

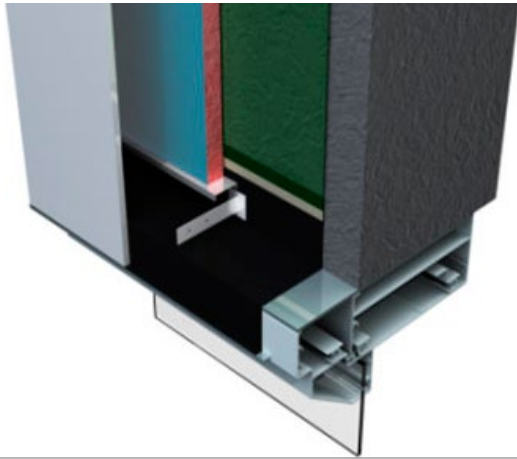

Effisus Ecork Facade

Effisus Ecork Facade is the integrated system that brings together, in a single system, the benefits of the sealing and water vapour management system for facades – Effisus Ecofacade Envelope – and the 100% sustainable solution – Effisus Ecork.

Eliminates the possibility of condensation and conditions associated with moisture, maximizing energy efficiency and acoustics.

The Effisus Ecork system for fronts is highly differentiated in terms of sustainability, not only because of the incorporation of Effisus Ecork cork, but also because of the protection that it gives the building against atmospheric elements, promoting indoor air quality and health of users.

Efficiency

- Complete and integrated system
- "Cutting Edge technology"
- Excellent thermal and acoustic insulation properties
- Waterproofing solutions with intelligent facade water vapour management
- Unique thermal delay properties
- Technical support from design to construction
- Certified contractors
- Superior resistance to wind action
- Excellent puncture and tear resistance
- Excellent resistance to UV's and high temperature ranges
- Excellent chemical compatibility and resistance to microbiological attack

Sustainability

- The most sustainable solution on the market
- Elevated longevity
- Promotes indoor air quality and users' health
- 100% natural and recyclable insulation
- High product life-expectancy
- Reduced maintenance needs
- "Energy Star certification"
- Without plasticizers
- Without chlorides, halogens or other harmful chemicals to the environment
- Low energy consumption in the production, installation and use
- Optional gasket system with no need of adhesives
- Reduced wastes through solution customization

-Brochure

-Data sheet

-MSDS

-Efficiency

-Applications

-Installation



**The most sustainable solution for facade and building protection.
Improved air quality and users' health.**

Effisus Wallyard

Vertical gardens Integrated system



Effisus Wallyard

The Effisus Wallyard system is the complete, integrated, efficient and sustainable weatherproofing system for vertical gardens.

Based on a modular system of panels with pre-developed vegetation, Effisus Wallyard system is the answer to the most demanding technical requirements of a vertical garden. Enables an immediate vertical garden.

The Effisus Wallyard system integrates, not only a state-of-the-art vertical garden and weatherproofing system, but also, an integrated automatic irrigation system.

Efficiency

- Complete and integrated system
- "Cutting Edge technology"
- Excellent thermal and acoustic insulation properties
- Waterproofing solutions with intelligent facade water vapour management
- Unique thermal delay properties
- Technical support from design to construction
- Automatic irrigation system
- Excellent resistance to UV's and high temperature ranges
- Excellent chemical compatibility and resistance to microbiological attack

Sustainability

- The most sustainable solution on the market
- Elevated longevity
- Promotes indoor air quality and users' health
- 100% natural and recyclable insulation
- High product life-expectancy
- Reduced maintenance needs
- "Energy Star certification"
- Without chlorides, halogens or other harmful chemicals to the environment
- Low energy consumption in the production, installation and use

System Components:

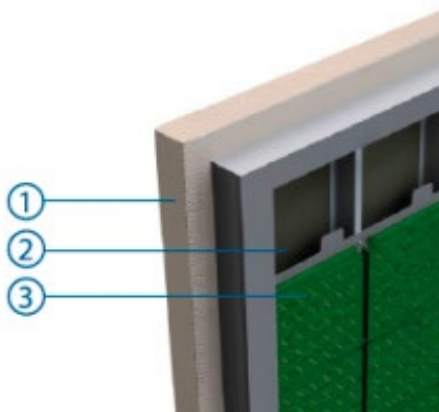

1 – Approved Thermal insulation
Optional 100% natural and recyclable Effisus Ecork Insulation

2 – Effisus Ecofacade Membrane
Waterproof membrane with an expected durability of 50 years, service temperatures of -40°C and +140°C and an elongation capacity of 300%.

3 – Effisus Wallyard panels
Pre-developed vegetation panels with an integrated irrigation system. Customisable vegetation and low maintenance requirements.

The modular integrated system for vertical gardens.

-Brochure

-Data sheet

-MSDS

-Efficiency

-Applications

-Installation



Roofing solutions

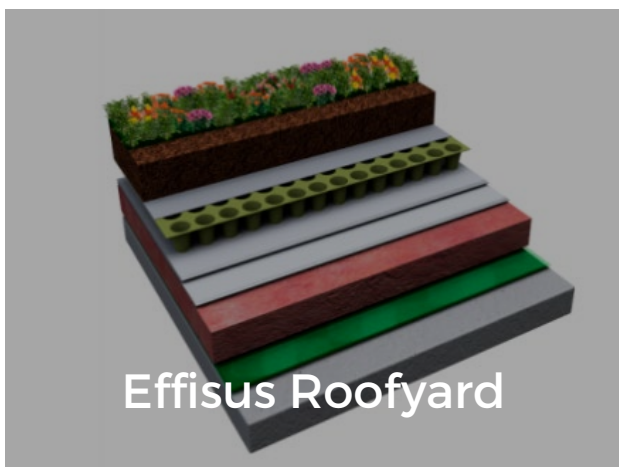
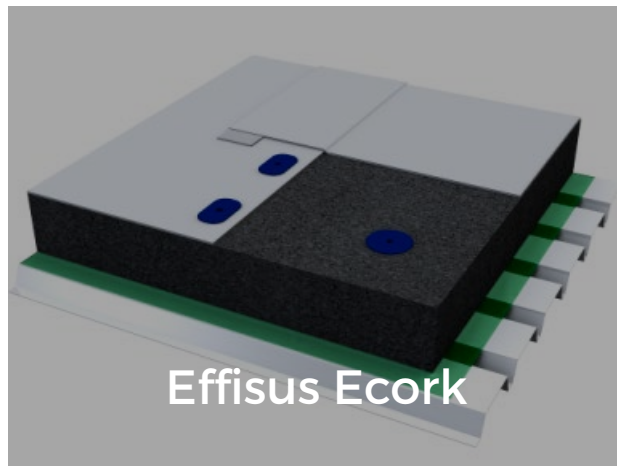
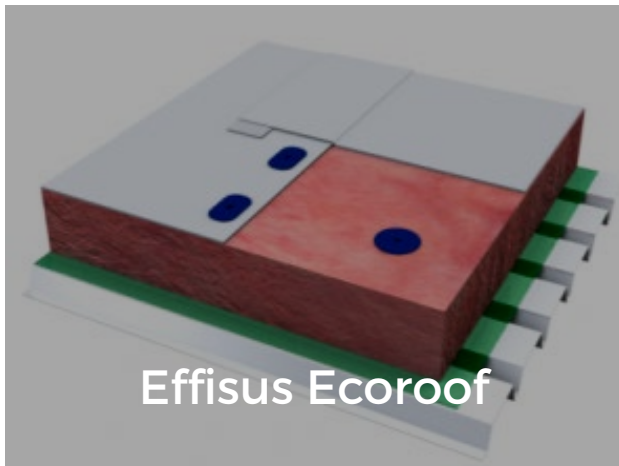

Effisus Ecoroof

Integrated system for roof waterproofing

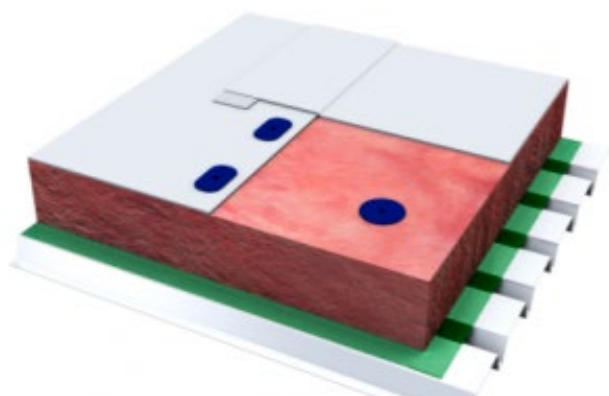

Effisus Ecoroof – Mechanical Fastening

The Effisus Ecoroof system is the complete, integrated, efficient and sustainable system for waterproofing metal decks, concrete slabs or wood roofs.

It's the answer to the most demanding technical requirements of residential, industrial and service buildings ensuring their sealing and energy efficiency. It provides unmatched performance and longevity, even in the most diverse environments, ensured by the best market guarantees.

Efficiency

- Complete and integrated system
- "Cutting Edge Technology"
- Superior thermal performance
- Sunlight reflectivity of up to 78%
- Technical support from project to construction
- Certified installers
- Superior wind action resistance
- Excellent puncture and tear resistance
- Excellent resistance to UV's and extreme temperature ranges
- Excellent chemical compatibility and resistance to microbiological attacks

Sustainability

- High longevity
- Low maintenance requirements
- Without plasticizers
- Without chlorides, halogens or other harmful chemicals to the environment
- Recyclable and reprocessible materials
- Energy Star Certification
- Low energy consumption during production, installation and use
- Repairable during product lifetime



Mechanical Protection



Mechanical Protection

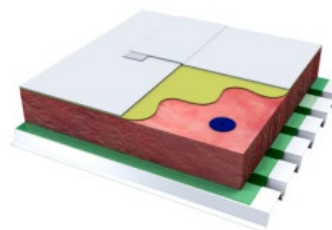

Sloped Roofs – Fully adhering Solution

The integrated system with high environmental awareness.

-Brochure

-Data sheet

-MSDS

-Efficiency

-Applications

-Installation



Effisus Ecork

Integrated system for flat roof waterproofing with cork insulation

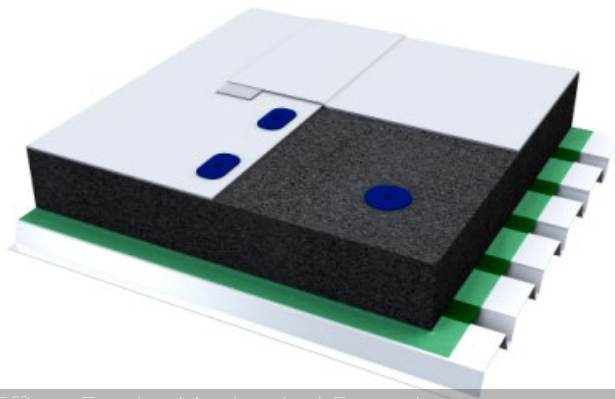

Effisus Ecork - Mechanical Fastening

Effisus Ecork is the fully integrated, efficient and sustainable system for flat roof waterproofing that combines all the Effisus Ecoroof System benefits and the 100% sustainable cork insulation benefits.

It's the answer to the most demanding technical requirements of residential, industrial or service buildings in terms of ensuring its tightness and energy efficiency.

The Effisus Ecork system is highly differentiated in terms of sustainability, not only by the incorporation of cork insulation, but also by Effisus Ecoroof waterproofing system, being the right choice for projects with high environmental demands.

Efficiency

- Complete and integrated system
- "Cutting Edge Technology"
- Superior thermal performance
- Exceptional thermal and acoustic insulation properties
- Unique thermal delay properties
- Up to 78% of sunlight reflectivity
- Technical support from design to construction
- Certified installers
- Superior resistance to wind action
- Excellent puncture and tear resistance
- Excellent resistance to UV's and high temperature ranges
- Excellent chemical compatibility and resistance to microbiological attack

Sustainability

- The most sustainable solution on the market
- Elevated longevity
- Reduced maintenance requirements
- 100% natural and recyclable insulation
- Without plasticizers
- Without chlorides, halogens or other harmful chemicals to the environment
- Recyclable and reprocessible membranes
- Membrane with Energy Star certification
- Low energy consumption in the production, installation and use
- Can be repaired during total lifetime

The most sustainable roof waterproofing system on the market.

-Brochure

-Data sheet

-MSDS

-Efficiency

-Applications

-Installation

in



Effisus Ecork

Integrated system for flat roof waterproofing with cork insulation



The best solutions are a result of the best partnerships.

The Effisus Ecork system results from a long-term industrial partnership with the world's largest producer of cork, Corticeira Amorim.

Cork is a 100% natural and ecological product, endowed with a constitutional inviolability, with guaranteed efficiency. Among the natural substances is one that has greater insulating power. By choosing to use cork in your project, you will be contributing to the protection of the environment, while enjoying all the advantages offered by the technical and acoustic characteristics of the material.



100% Natural Expanded Insulation
Corkboard

-Brochure

-Data sheet

-MSDS

-Efficiency

-Applications

-Installation

in



You
Tube



Effisus Roofyard

Green roof integrated system for flat roof waterproofing

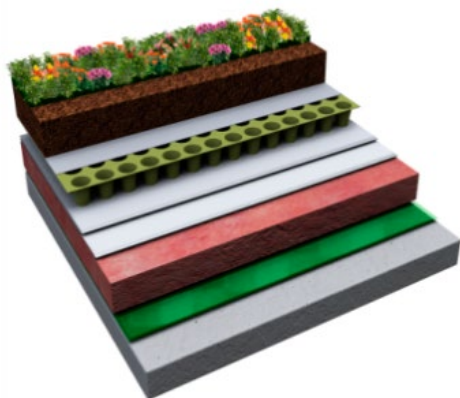

Effisus Ecork Roofyard

Effisus Roofyard is the complete, integrated, efficient and sustainable waterproofing system integrating a green roof.

The Effisus Roofyard system combines in a single system, all the benefits of the Effisus Ecoroof waterproofing system and the most evolved green roof solution on the market. It's the answer to the most demanding technical requirements of residential, industrial or service buildings,

with an unmatched performance and longevity.

The Effisus Roofyard system is highly differentiated in terms of sustainability, not only due to the green roof aspect, but also because of the Effisus Ecoroof waterproofing system. It is therefore the ultimate choice for projects with high environmental demands.

Efficiency

- Fully integrated system
- "Cutting Edge Technology"
- Superior technical performance
- Promotes a higher energy-efficient of the building
- Immediate green coverage due to the pre-grown vegetation
- Technical support from project to construction
- Excellent resistance to microbiological attacks and huge chemical compatibility

Sustainability

- High longevity
- Low maintenance requirements
- Contributes to the sustainability of urban environments
- Reduction of greenhouse gases
- Decreased risk of flooding
- Increases building financial value
- "Energy Star Certification"
- Without chlorides, halogens or other harmful chemicals to the environment
- Recyclable and reprocessible materials



The most sustainable waterproofing green roof system on the market.

-Brochure

-Data sheet

-MSDS

-Efficiency

-Applications

-Installation



Innovative Outperforming Solutions



Effisus Stopper



Effisus Easyrepair



Effisus Stopper MR



Effisus Cobra

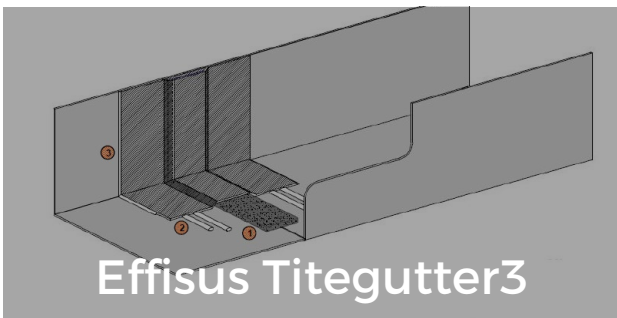

Effisus Titegutter3



Effisus 2Bond DS



Effisus Bond GF

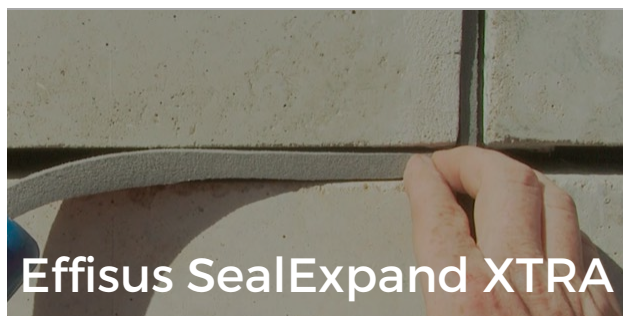

Effisus SealExpand XTRA



Effisus 2Bond GO



Effisus EverydaySeal XTRA



Effisus Stopper

Penetration sealing solution for roofs and facades



Effisus Stopper is an innovative solution for sealing penetrations, of any size or configuration, on flat roofs.

Effisus Stopper can be installed on the most common roofs: asphaltic membranes, PVC, TPO, EPDM or metal. Application on sloped, metal roofs is also possible.

It is an extremely versatile solution, with precast moulds and innovative sealants, quick and easy installation – no need for mechanical fastening and adaptable to any configuration. It is the quick and easy to install waterproofing solution, with a long-term warranty.



1 – Effisus Stopper 1-P Sealant
2 – Effisus Stopper M-1 Sealant
3 – Effisus Stopper Pre-cast moulds

Efficiency

- Flexible design, adaptable to any configuration
- 100% waterproof, resistant to UV's and ozone
- Permanently flexible
- Easy to install. Simple to handle materials and commonly used accessories
- Supplied in kits for complete installation
- Technical support to any project

Sustainability

- Great longevity
- No maintenance required
- Sealants without solvents
- Without VOCs
- Doesn't release harmful gases - guarantees indoor air quality



Multiple penetrations

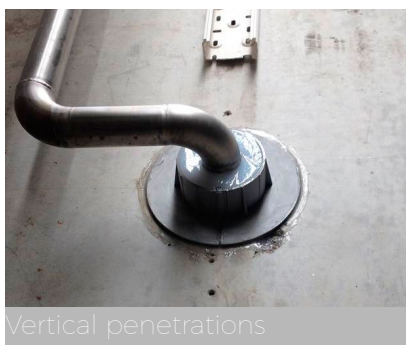

Vertical penetrations

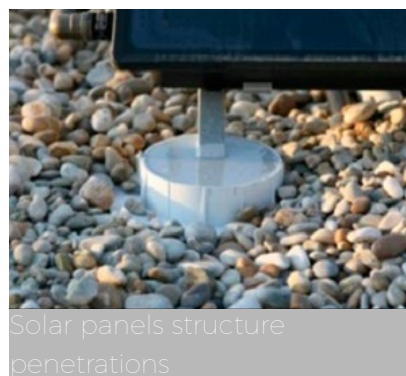

Solar panels structure penetrations

The solution to the n°1 cause of leaks in roofs.

Effisus Easyrepair

The ultimate leakage sealing solution for roofs and facades

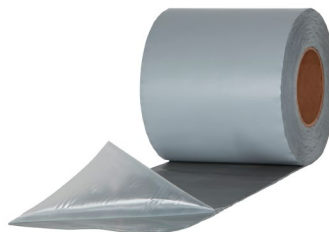

Effisus Easyrepair

The Effisus Easyrepair membrane is the innovative, efficient and sustainable solution for permanently sealing leaks. The active sealing technology adhesive ensures superb adhesion to virtually any construction material. It's the solution that will revolutionise the way customers solve infiltration induced problems.

Ideal for sealing joints on roofs, roof penetrations, skylights, covers, gutters, etc. Very simple to install, no need of any accessory or additional adhesive.

Efficiency

- "Cutting Edge Technology"
- 100% waterproof
- Exceptional adhesion to the most common materials
- Ideal for use in extreme industrial environments
- Adhere to the surface at a molecular level = higher surface adhesion
- With an embedded primer
- Resistance to UV's and flexibility up to -56°C
- Application in a single step without the need of accessories

Sustainability

- Lifespan expectancy superior to 20 years
- No need for chemical accessories
- Without solvents
- Without VOC's
- Does not release harmful gases, thus guaranteeing the quality of the air inside the buildings
- Extremely stable against the action of atmospheric agents

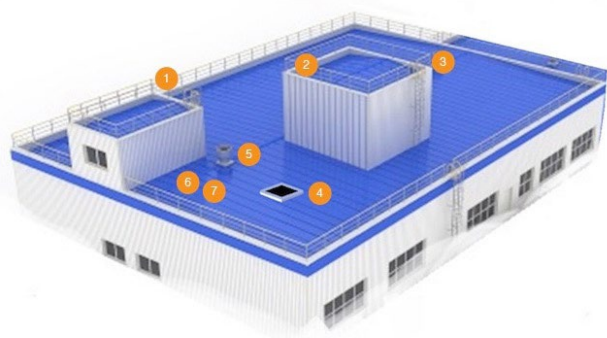

Typical Applications

1. Polycarbonates
2. Cladding
3. Skylights
4. Flashings
5. Gutters
6. Thresholds
7. Parapets

The ultimate leakage sealing solution for roofs and facades.

Effisus Easyrepair

The ultimate leakage sealing solution for roofs and facades

Technology with Active Sealants

The Effisus Easyrepair membrane uses an innovative technology with active sealants. This technology uses sealants that do not contain double bonds between their carbon atoms, forming an extremely stable molecular structure. Resistant to oxygen, ozone, and extreme continuous temperature variations, it is also extremely tolerant to chemical contact.

By encapsulating a primer, the obtained adhesive bonds at a molecular level with the surface on which it is applied, guaranteeing an exceptional adherence to various materials commonly used in construction. Applicable in environments with temperatures between -56°C and up to +93°C.

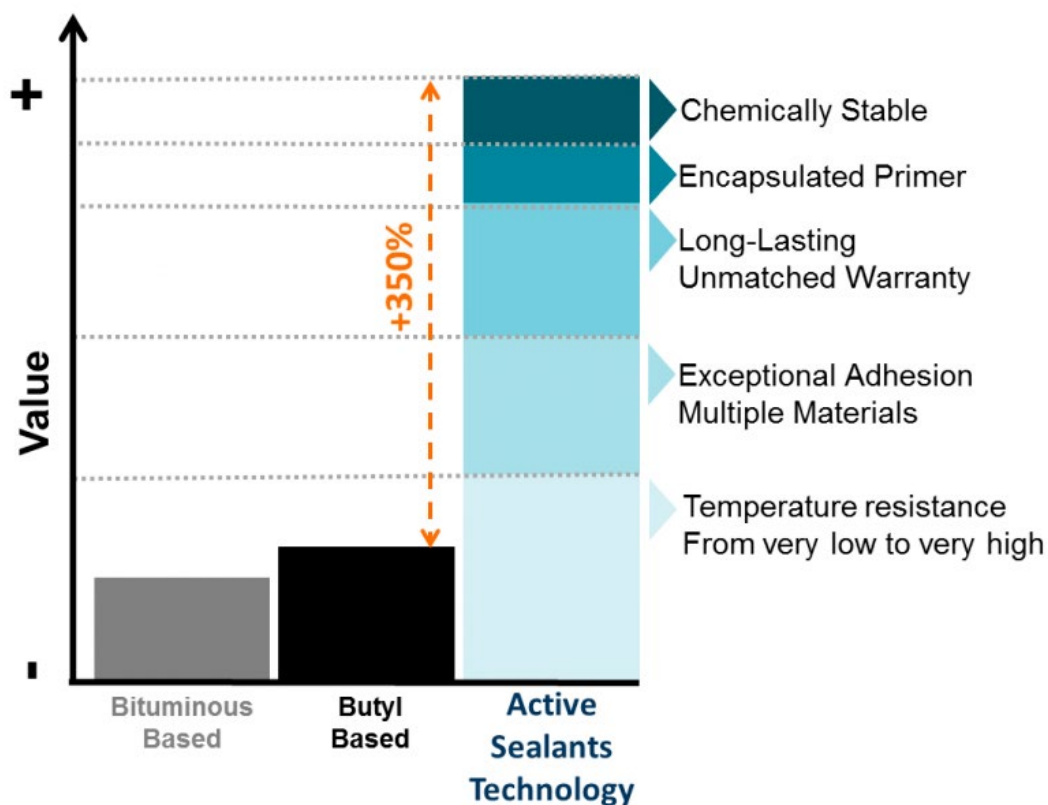

Application Examples

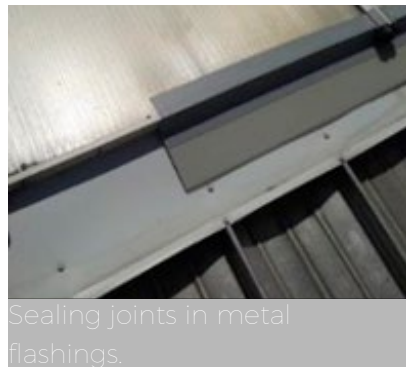

Effisus Stopper MR

Penetration sealing solution for metal roofs



Effisus Stopper MR is the efficient and sustainable solution for the permanent sealing of penetrations in metal roofs, with diameters from 0 to 750mm.

Combining its EPDM composition to a laminated aluminium base, it allows a perfect fit to virtually any configuration of the roof profile.

Its flexibility ensures absorption of roof movements or vibrations, resisting the most aggressive atmospheric conditions. The different design options allow it to meet the different requirements of each project, as well as the different types of metal roof penetrations. Facade application also possible.

Efficiency

- Flexible design that meets the most diverse requirements of each project
- 100% waterproof, resistant to UV's and ozone
- Perfectly adaptable to any roof profile
- Each dimension covers a wide range of diameters
- Remains flexible up to -57°C
- Easy to install. Simple to use materials and common accessories
- Supplied in kits for complete installations
- Technical support

Sustainability

- Great longevity
- No maintenance required
- Without plasticizers, chlorine or halogens
- Recyclable materials
- Adhesive without solvents



Effisus Stopper MR

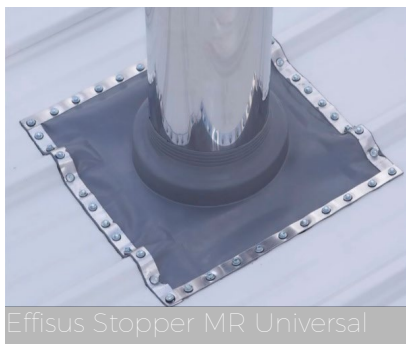

Effisus Stopper MR Universal



Effisus Stopper MR Retrofit

Sealing guaranteed in virtually any roof profile.

Effisus Cobra

Penetration and connection sealing solution for metal roofs



Effisus Cobra is the efficient and sustainable solution for permanent sealing of metal roof penetrations and connections.

The Effisus Cobra Membrane combines its EPDM composition to two aluminium strands incorporated and ribbed on both edges.

The great EPDM elongation capacity combined with the capacity of deformation and memory of the ribbed aluminium strands ensures that Effisus Cobra is the solution to seal penetrations in virtually any type of metal roof. This is done by following-up the straight surfaces as well the corrugated metal roof profiles. Effisus COBRA solves the hard problem of sealing connections and penetrations in such demanding situations.

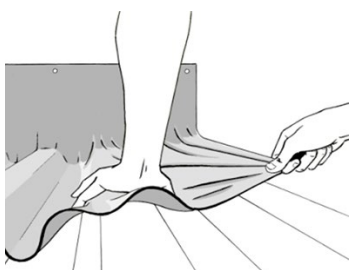

Efficiency

- Excellent resistance to UV's and ozone
- Fast and easy to install
- Resistant to extreme temperature variations
- High elasticity – absorbs expansion and structural vibrations
- Adaptable to the requirements of each project
- Technical support from project to construction

Sustainability

- Great longevity
- No maintenance required
- Without plasticizers, chlorine or halogens
- Recyclable materials
- Adhesive without solvents

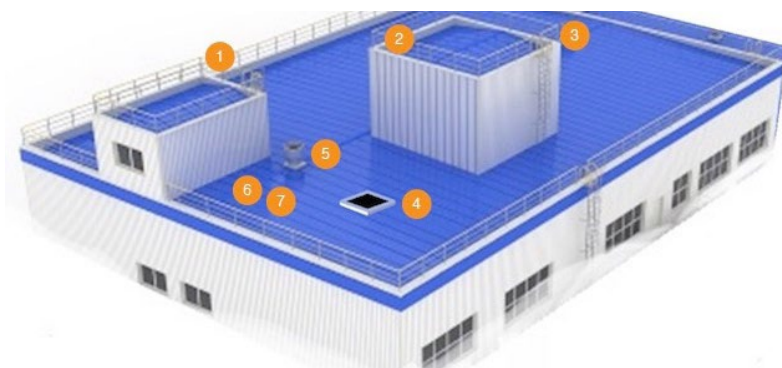

Typical Applications

1. Parapets
2. Facades
3. Roof Penetrations
4. Skylights
5. Ducts
6. Ridges
7. Roof valleys

Elongation up to 300%. Guaranteed sealing in any type of roof profile.

-Brochure

-Data sheet

-MSDS

-Efficiency

-Applications

-Installation



Effisus Titegutter3

Integrated system for sealing gutter joints



Effisus Titegutter3 is the innovative integrated system for sealing gutter joints. The system's efficiency and added value are guaranteed by its 3 waterproofing levels. Its constituents are free of harmful substances, such as heavy metals or solvents, and are subject to strict quality control guidelines. Moreover, their properties give it the capacity of accommodating joint movements originated by structural or thermal expansion.

Due to its speed and ease of application, the job can be done without the need of specialized labour or heavy machinery, largely reducing completion time.. With Effisus Titegutter3, one can reduce the probability of human error, reduce application time and assure gutters' waterproofness.

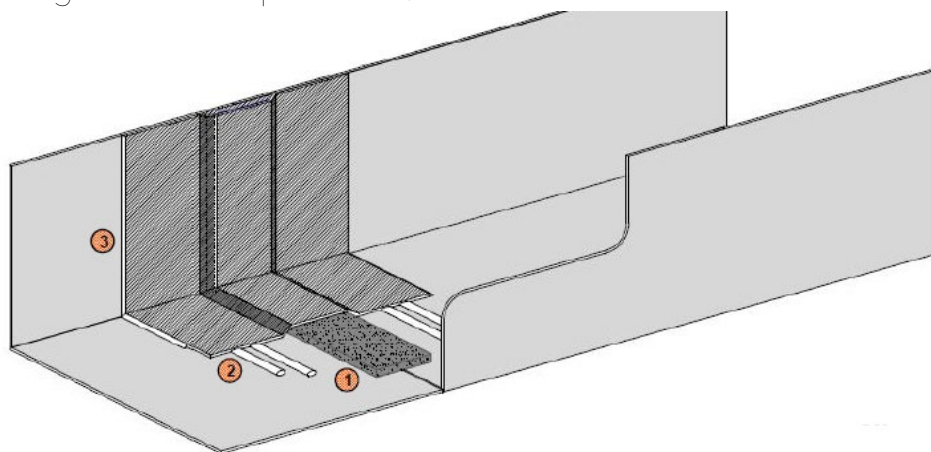

Level 1	Level 2	Level 3
Effisus 2Bond DS Tape	Effisus Ecofacade Membrane and Effisus Bonding KF+P Adhesive	Effisus Bonding KF+P Adhesive
<ul style="list-style-type: none">-100% waterproof and both air and moisture tight-Flexible up to -57°C-Microsealant with exceptional adhesiveness-Double-sided adhesive tape	<ul style="list-style-type: none">-Resistant to UVs and extreme temperature variations-Recyclable and with an elongation of up to 300%-Tough, puncture resistant and 100% waterproof	<ul style="list-style-type: none">-Permanently flexible-UV resistant

Solution benefits

- Robust – High elongation capacity and adhesiveness, handles structural movement.
- Durable – Resistant UVs and extreme temperature changes.
- Universal – Compatible with any gutter joint sealing requirement.
- Flexible – Complies with the requirements of different construction sites
- Easy to install – Easy to handle materials and common use accessories.

Effisus 2Bond DS

Permanent solution for sealing between two surfaces or nail/screw perforations

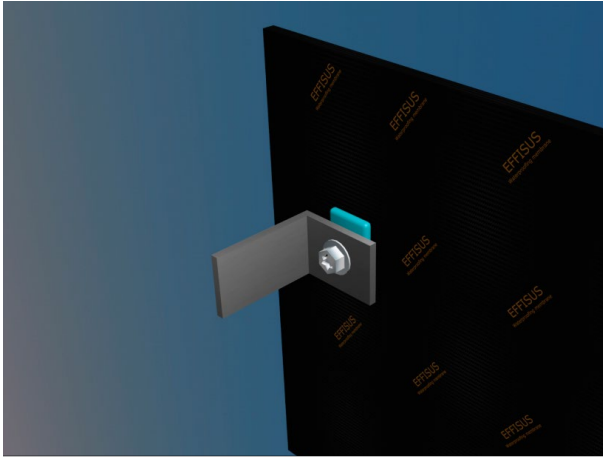

Effisus 2Bond DS



Effisus 2Bonds DS

Effisus 2Bond DS is the efficient and sustainable solution for sealing between two surfaces, of the same or different materials, and sealing any kind of nail/screw penetration.

The Effisus 2Bond DS tape is a double-adhesive tape, based on an advanced technology with active adhesive sealants that ensure excellent adhesion to the most diverse materials: polycarbonate, glass, metals, natural stone, concrete, plaster or ceramic. It is available in 0.77mm or 1.54mm thick, and widths from 25mm to 76mm.

Efficiency

- "Cutting Edge Technology"
- Permanent waterproof and airtight
- Exceptional adhesion to various materials
- Permanent sealing of any joint or point of infiltration
- Ideal for use in extreme industrial environments
- Adhere to the surface at a molecular level = higher surface adhesion
- With an embedded primer
- Flexibility up to -56°C
- Application in a single step without the need for accessories
- Different options for different requirements

Sustainability

- Lifespan superior to 20 years
- Accessories not needed
- Without solvents
- It doesn't release harmful gases, therefore ensuring the indoor air quality of the buildings
- Extremely stable against the action of atmospheric agents

Permanent sealing solution for nail / screw perforations or inter-material connections.

-Brochure

-Data sheet

-MSDS

-Efficiency

-Applications

-Installation



Effisus 2Bond DS

Permanent solution for sealing between two surfaces or nail/screw perforations

Technology with active sealants

The Effisus 2Bond DS tape uses an innovative technology with active sealants. This technology uses sealants containing no double bonds between their carbon atoms, resulting in an extremely stable molecular structure. Resistant to oxygen, ozone, extreme and continuous temperature variations, it is still extremely tolerant to chemical contact.

By encapsulating a primer, the obtained adhesive bonds at a molecular level, with the surface on which it is applied, guaranteeing an exceptional adhesion to the different materials commonly used in construction. Applicable in environments with temperatures between -56°C and up to $+93^{\circ}\text{C}$

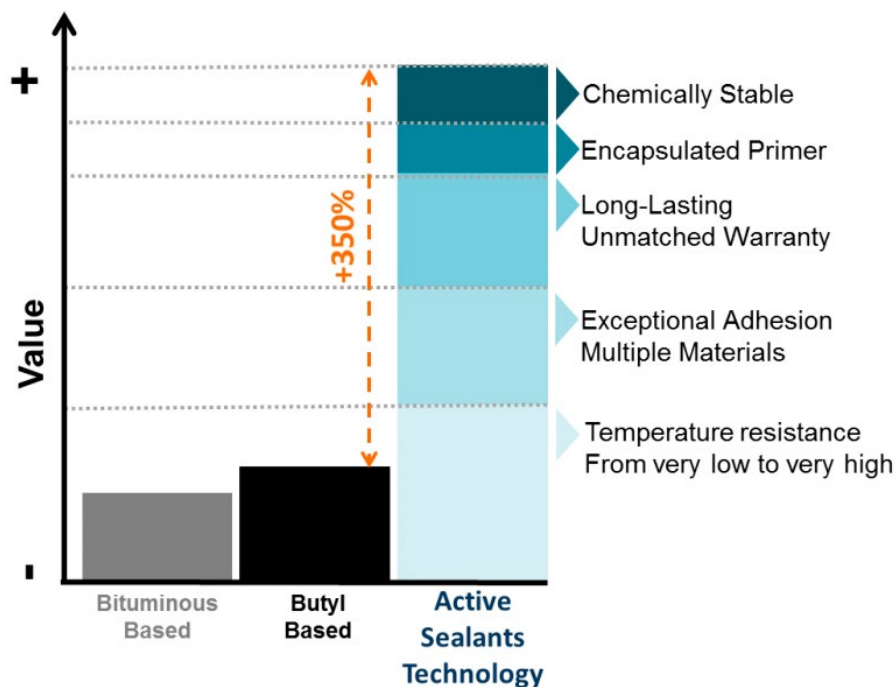

Typical Applications

- Sealing nails / screw perforations
- Sealing screw plates
- Sealing fixing guards
- Sealing setting profiles in facades
- Sealing fixing profiles on roofs

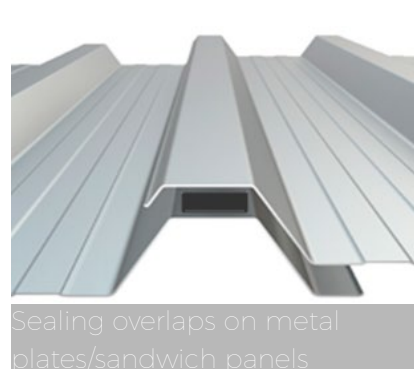
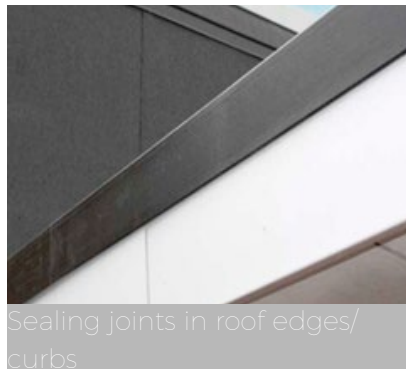

-Brochure

-Data sheet

-MSDS

-Efficiency

-Applications

-Installation



Effisus Bond GF

Permanent sealing solution for irregular configurations



Effisus Bond GF

Effisus Bond GF is the efficient and sustainable solution, for sealing surfaces with irregular configurations.

The tape incorporates excellent adhesion properties, coated with a transparent PE film, highly elastic and extensible (longitudinal and transversal). Perfect adherence to VAP and Breather membranes.

GF tape is ideal for sealing objects with irregular shapes, ensuring a permanent and elastic seal.

Efficiency

- "Cutting Edge Technology"
- 100% waterproof
- Excellent elongation and deformation capacity to adapt to uneven surfaces with irregular configuration
- Exceptional adhesion to various materials
- Permanently flexible
- Different options for different requirements
- Ongoing technical support

Sustainability

- Great longevity
- No maintenance required
- Without solvents
- Adhesion resists cold temperatures without adhesives

Typical Applications

- Trims with irregular profiles
- Trims with pipes and/or conduits
- Sealing corners and other trim gravels
- Sealing corners and other trims in metal roofs
- Repairs

The flexible solution for sealing surfaces with irregular configurations.

-Brochure

-Data sheet

-MSDS

-Efficiency

-Applications

-Installation



Effisus SealExpand XTRA

Impregnated self-expanding joint-sealing tape



Effisus SealExpand XTRA

The Effisus SealExpand XTRA tape is the efficient solution for sealing joints and perimeters, in new buildings or rehabilitation works. The tape's properties concede it an excellent expandability and permanent elasticity, which enable it to absorb movements during the different phases of a building's lifecycle. Moreover, the tape is resistant to UV radiation and rainwater with pressures up to 1000Pa. All this without the need for additional coatings or sealants.

Effisus SealExpand XTRA's added value is due its thermal and acoustic insulation properties, which not only increase energy efficiency, but also improve the quality of buildings' indoor spaces.

Effisus SealExpand XTRA Tape:

- Increased ageing resistance
- Service temperatures from -30°C e +90°C
- Standard widths from 10mm to 50mm
- Thermal and structural vibration-proof
- Adapts do any unevenness inside the joint
- B1 Flammability Rating
- Paint coating and sealant compatible
- Solvent-free, no hazardous materials
- Variants from 300Pa to 1000Pa
- Possible last-minute orders



Effisus SealExpand XTRA

Typical Applications:

- Prefabricated construction in concrete or other materials
- Sealing perimeters of frames (windows/doors)
- Skylights
- Cladding Panels
- Curtain Walls

Solution benefits

- Robust – 100% waterproof, UV resistant
- Universal – Variants for different needs
- Durable – High life-expectancy
- Flexible – Adapts to on-site demands
- Easy to apply – Simple to handle and no need for accessories

-Brochure

-Data sheet

-MSDS

-Efficiency

-Applications

-Installation

in



You
Tube



Effisus 2Bond GO

Double-sided butyl sealing tape



Effisus 2Bond GO

whilst also improving the energy efficiency of systems and solutions. It adheres perfectly to vapour barriers, weatherproofing membranes, and most remaining construction materials.

The Effisus2Bond GO tape is the innovative solution for day-to-day building or rehabilitations works. The solution's high performance and added value are guaranteed, not only, due to its strict quality control process, but also, due to its high quality constituents, free of harmful substances, such as solvents, chlorine, heavy metals and others. The solution's post production quality is assured by its silicon-based film coating.

It promotes the protection of constructive materials, towards condensation and leaks.



Effisus 2Bond GO Tape:

- Exceptional adhesiveness
- Increased ageing resistance
- Service temperatures from -30°C e +80°C
- No need for extra accessories
- Standard widths from 10mm to 50mm
- Thermal and structural vibration-proof

Typical Applications

- Sealing overlaps in weatherproofing membranes or vapour barriers
- Sealing joints and perimeter connections of vapour barriers and weatherproofing membranes
- Sealing connections between insulation boards
- Sealing connections between two surfaces
- Sealing perforations / penetrations
- Repairs

Solution benefits

- Robust – 100% waterproof, UV resistant and excellent adhesiveness
- Universal – Different widths for different needs
- Durable – High life-expectancy
- Flexible – Adapts to on-site demands.
- Easy to apply – Simple to handle materials and no need for accessories

-Brochure

-Data sheet

-MSDS

-Efficiency

-Applications

-Installation



Effisus EverydaySeal XTRA

Sealing tape for general applications



Effisus EverydaySeal XTRA

Effisus EverydaySeal XTRA is a tear resistant, UV and long-lasting, water resistant aluminium butyl rubber tape with very high tack and superior ageing resistance. It is used for masking applications and for sealing of insulations, pipework and ducts in HVAC applications. The tape provides a reliable sealing of metals, wood, and plastics as well as masonry and clean concrete surfaces.

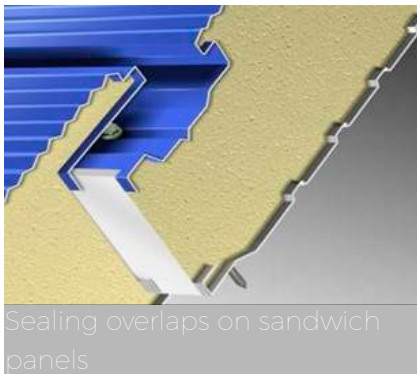

Sealing overlaps on sandwich panels

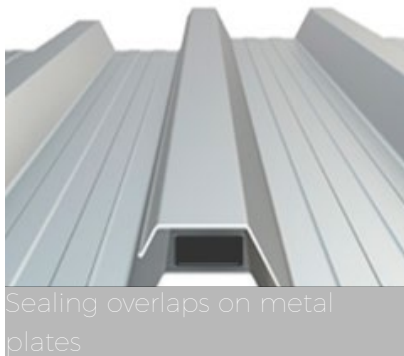

Sealing overlaps on metal plates



Sealing joints in roof ridges

Effisus EverydaySeal XTRA:

- Adhesive tape, with a butilic base, with a laminated PET/Alu/PET Composite, UV resistant coating.
- The adhesive is coated with a silicon based film, for an easier application.
- For sealing general flashing details, in the construction industry and others.

Typical Applications

- Sealing details on air-conditioning, heating or ventilation, pipes or ducts
- Sealing connections between insulation panels
- General repairs on gutters, downspouts, and others
- General repairs on metal roofs or facades
- Industrial applications

Solution benefits

- 100% waterproof and UV resistant
- Aluminium film coating
- Service temperatures: -30°C to + 80°C
- Available widths: 50 - 600mm
- Colour: Grey (other colours available on request)

-Brochure

-Data sheet

-MSDS

-Efficiency

-Applications

-Installation



Consulting

Effisus solutions combine in an innovative and balanced way Efficiency and Sustainability, promoting integrated systems with high added value and superior quality.



The Effisus Consulting services are the ultimate added value throughout the whole process, functioning as the global guarantee of step by providing comprehensive support for every phase and participants, in order to ensure complete success.

Effisus Consulting leads the process, ensuring added value and involving the various agents!



Project owner

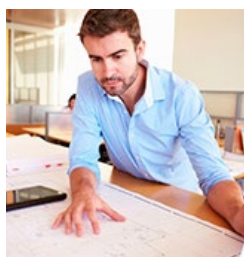

Specifier



Contractor



Certified
installer

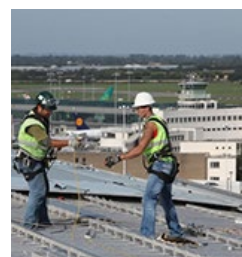

Inspector

During any stage of the construction, working globally, either on the construction sites or in the office, Effisus Consulting supports the various project participants.



Projects Portfolio

We aim to lead the development of efficient and sustainable solutions for the construction industry, investing in long-term strategic partnerships with global reference partners.

As a result of long-term alliances with global reference partners, Effisus is present in different continents and in world leading projects.



Fountain Views

Four Seasons Abu Dhabi

SSE Hydro Arena – Scotland

Dublin Airport, Terminal 2 – Ireland

Masdar Headquarters

Stade de Lille

Hotel citizenM Paris

Hotel Myriad

Zaragoza Exposition Centre

Diagonal Zero Zero – Barcelona

Luanda Arena

King Abdullah Sports City



Fountain Views - United Arab Emirates



The Fountain Views complex is a mixed-use development, comprised of three 60 storey towers, with 786 apartments and a new Address hotel with 194 rooms, in Dubai. The three towers have an astonishing view of the world's tallest building, the Burj Khalifa, and of the world's highest performing fountain, the Dubai Fountain. Moreover, as an integral part of the expansion of The Dubai Mall (one of the world's largest shopping destinations), the Fountain Views are directly linked to it through a metro link. Amenities include a fully equipped health club,

swimming pools, a rooftop recreation deck, and more. The development features an unique scalloped façade, with an alternating pattern in the placement of its double-glazed floor-to-ceiling windows and adjacent balconies. The chosen solution for sealing the towers' facade connections was the Effisus Ecofacade membrane. This was done in order to, not only protect the buildings from water damage, but also to improve their energy efficiency.

Applied Solution



Effisus Ecofacade
Facade waterproofing solution



Four Seasons Abu Dhabi



The luxurious Four Seasons Hotel in Abu Dhabi is placed next to the city's new financial district, Sowwah Square, in Al Maryah Island (Island to be a new city centre). The hotel is located in a 10 600 sq/m site, having 34 floors, which round up to 200 hotel rooms and 120 apartments. The building's external aluminium and glass shading were developed to help mitigate solar radiation. To guarantee the building's protection against the harsh surrounding environmental conditions and to assure the quality of its indoor air, Effisus Ecofacade was applied. Effisus Ecofacade was

used to seal the building's façade connections, such as windows, metal frames, and more.



Applied Solution



Effisus Ecofacade
Facade waterproofing solution

SSE Hydro Arena – Scotland



The Hydro Arena was designed in a way to maximize energy efficiency. The building combines natural ventilation with mechanical ventilation – fresh air enters the building above the entrances, and is ventilated to a higher level. Externally, the Hydro Arena is covered with light translucent panels that emit the effects produced in its interior. All of the building can be lightened, being reflected on the sea, just like a lighthouse.



Applied Solution



Dublin Airport, Terminal 2 – Ireland



The Dublin Airport's Terminal 2 is a 75,000 m² terminal and pier, which provides 19 air bridges for aircraft and is capable of handling 15million passengers every year – roughly 40% of the airport's total capacity. The terminal construction started in 2007 and in 2010 it was officially opened. Being an enormous closed public area and housing a large number of people everyday, where the reasons that made it so important to make sure that energy efficiency was as high as possible and that the interior air quality would have to be at its best throughout all the seasons.



Applied Solution



Masdar Headquarters



The Masdar Headquarters was designed as the world's first mixed-use, positive energy building. Through the use of sustainable design strategies and systems, the project's energy production is higher than its consumption. Effisus Ecofacade was chosen for sealing the connections between the building's facade and its elements, such as windows, steel frames and others.



Applied Solution



Effisus Ecofacade
Facade waterproofing solution



Stade de Lille

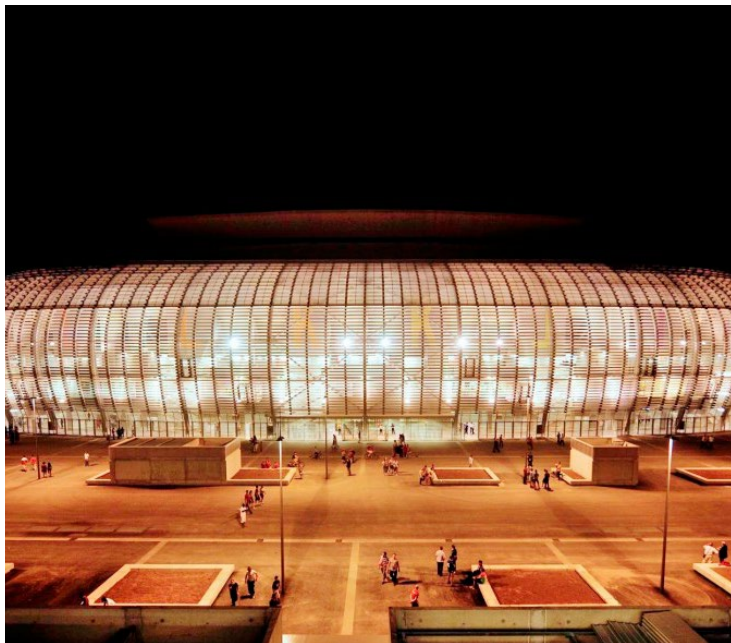

The Lille Stadium, with over 50 000 seats, was designed in a way so that the communication with the exterior would be possible, using lighting and screens in its facade. The stadium possesses a retractable roof that can open and close in 15 minutes, depending on climate conditions. Also, so that the stadium could have multiple functionalities, half of the pitch sits on top of a hydraulic elevator, that when raised, covers the remaining half of the pitch and exposes another pitch-level area with extra seating spaces.



Applied Solution



Effisus Ecofacade
Facade waterproofing solution



Effisus Sealexpend XTRA
Impregnated self-expanding
joint-sealing tape



Hotel citizenM Paris



The citizenM hotel in Paris was developed while having innovation in mind. An example of this is that room temperature, lights and curtains, can all be controlled through a tablet. To guarantee a weatherproof facade, Effisus Ecofacade and Effisus Ecofacade SA-Edge were both used.

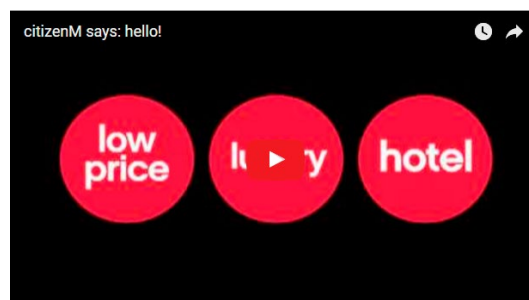

Applied Solution



Effisus Ecofacade
Facade waterproofing solution

Hotel Myriad



The luxurious Myriad Hotel in Lisbon, is situated in an unique location, with a panoramic view of Lisbon and the river Tagus. The hotel has 176 rooms, 10 suites and reserved areas for conferences and events. Its two lateral sail-shaped bodies and its breath-taking vertical entrance, are considered an architectural and engineering masterpiece and fill its interior with natural light. Effisus Ecofacade was used to seal all of the hotel's facade connections, such as its windows, to ensure its watertightness, airtightness, and increased energy efficiency.



Applied Solution



Effisus Ecofacade
Facade waterproofing solution



Zaragoza Exposition Centre



The Zaragoza Conference Centre is located next to the bank of river Ebro, in Zaragoza. The building has 22 285m² of floor space and a maximum height of 34m. The project was finished for the celebration of the International Exhibition Expo 2008. Nowadays, the building is used for multiple activities, such as conventions, professional events, musical and theatrical shows. The structure is wrapped in a winding covered with skylights, to allow the passage of sunlight into its hallways and common rooms. Effisus Ecofacade was used to seal the building's

facade connections, ensuring its watertightness, airtightness and improved energy efficiency.

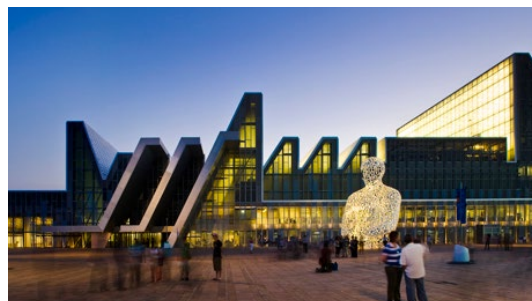

Applied Solution



Effisus Ecofacade
Facade waterproofing solution



Diagonal Zero Zero – Barcelona



The Diagonal Zero Zero, is a skyscraper in Barcelona, Spain. The building has a height of 110m, with 24 floors, and is located in the city's main avenue. The project is an example of high-tech architecture. The perimeter structure is split in two rings: an interior vertical structure and an exterior bracing lattice supporting the structural movements produced by wind or earthquakes. Effisus Ecofacade was the chosen solution for sealing the building's facade connections. Effisus Easyrepair was used to seal the perforations made through the building's windows.



Applied Solution



Effisus Ecofacade
Facade waterproofing solution



Effisus Easyrepair
The ultimate leakage sealing
solution for roofs and facades.

Luanda Arena

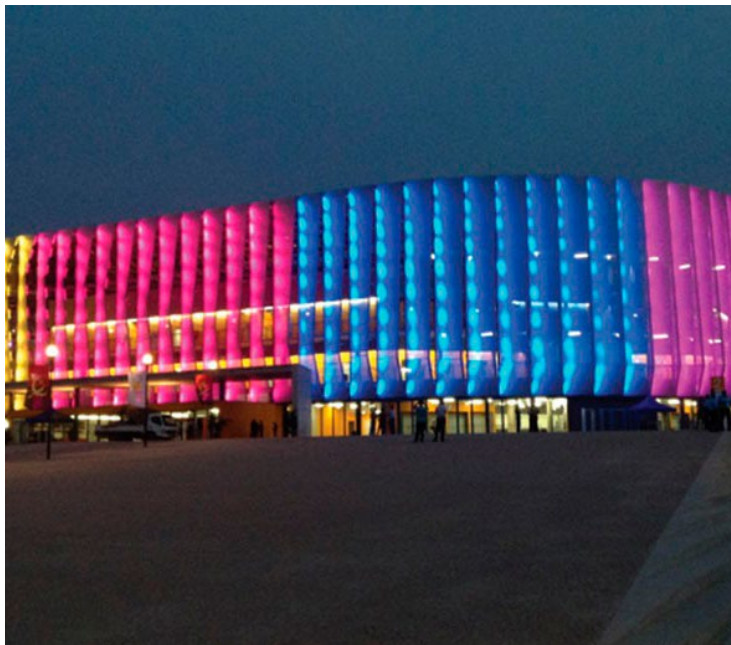

The Luanda Arena, is a state-owned multi-purpose indoor arena in Angola. Construction of the 30 000 m² infrastructure took only nine months and fifteen days. The arena has a seating capacity for 12 720 people and includes a variety of features that make it the most advanced in Africa. The arena is known for several events, including basketball, handball, roller hockey and volleyball. With the arena's removable stands, it is possible to increase the field area from 2 000 m² to 3 490 m², whilst losing 2 838 seating spaces. Due to the heavy rain periods during Winter

and Spring, and high temperatures throughout the year, having a 100% weatherproof roof was a top priority.



Applied Solution

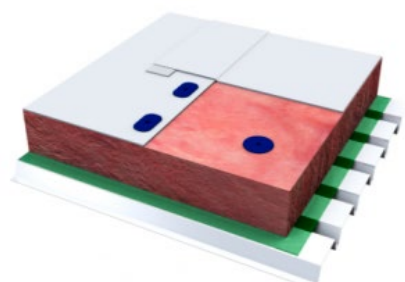

Effisus Ecoroof
Integrated systems for roof
waterproofing.

King Abdullah Sports City



The King Abdullah Sports City, is a new sports city, that includes a multi-purpose stadium, located in Saudi Arabia. The main stadium, the King Abdullah International Stadium, built according to the FIFA standard football venue requisites, has a capacity of 62 241 spectators. There are multiple smaller sports venues located around the stadium, hosting athletics and other indoor/outdoor sports. The diamond patterned façade and roof were built to mediate the breezes and provide shade. This enabled the bowl to be naturally ventilated and still comfortable in the hot and humid surrounding environment.



Applied Solution

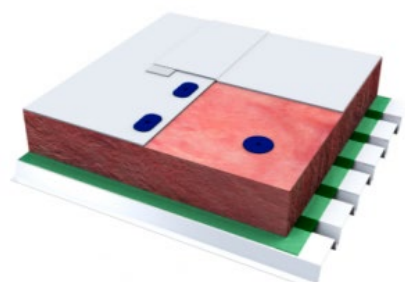

Effisus Ecoroof
Integrated systems for roof
waterproofing.



Contacts

We aim to lead the development and trading of sustainable and efficient solutions for the construction industry, by investing in long-term strategic partnerships with global reference partners.

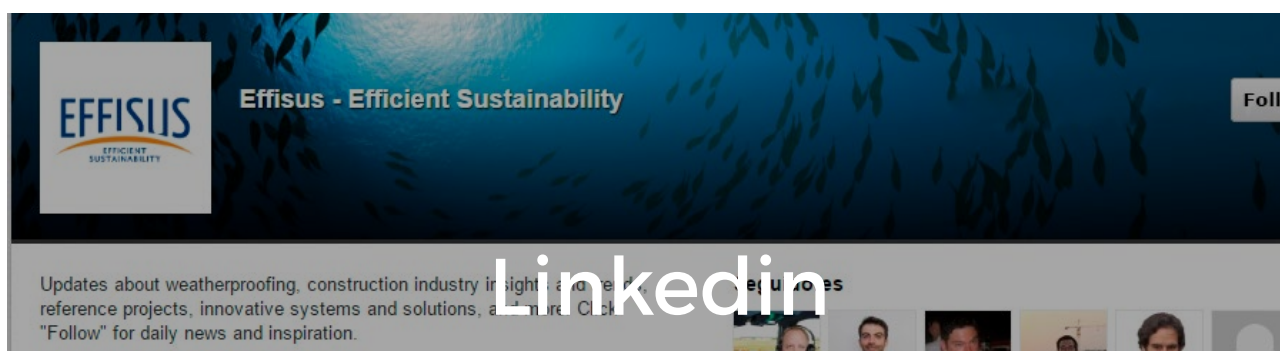
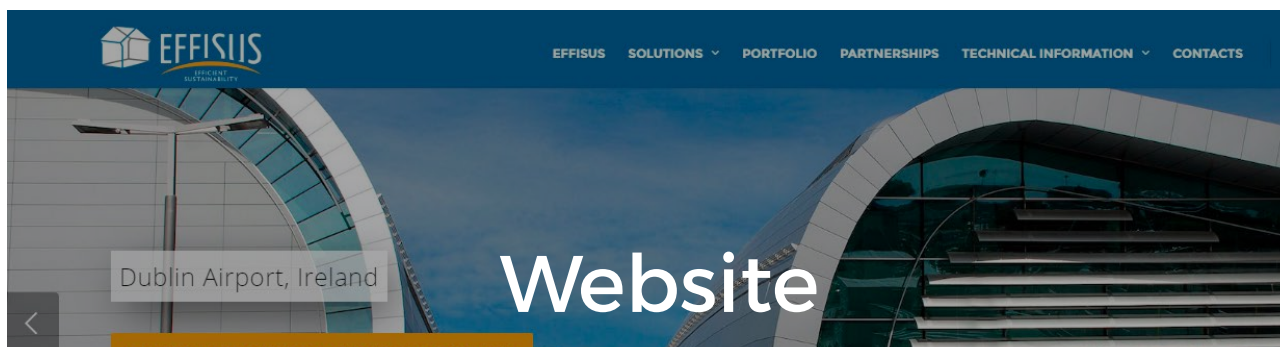

Email: geral@upwaysystems.com
Telephone: +351 252 809 121

CONTACT EFFISIUS



EFFISUS

EFFICIENT
SUSTAINABILITY

Dublin Airport T2 - Ireland